**DESCRIPTION**

Motors, on/off switches, wires and PCBs

Cable sets

Body and body parts

Dust bags and filters

Hoses, connections and tubes

Nozzles

PLAN

A - 5.6.3 - 2

A - 5.6.3 - 4

A - 5.6.3 - 6

A - 5.6.3 - 8

A - 5.6.3 - 10

A - 5.6.3 - 12

BASIC - X100, X110

MEDIUM - X150, X200, X210

PREMIUM - X300

Specifications are subject to change without further notice.

Nilfisk-Advance

SAS au capital de 150 000 €

GRAND PUBLIC

B.P. 246

91944 COURTABŒUF Cedex

Tel. : 01.69.59.87.24

Fax : 01.69.59.87.81

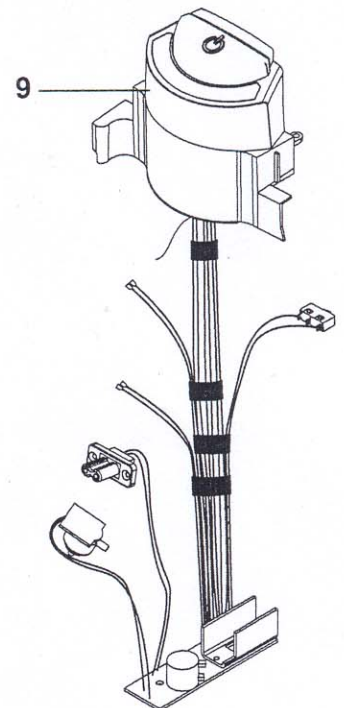
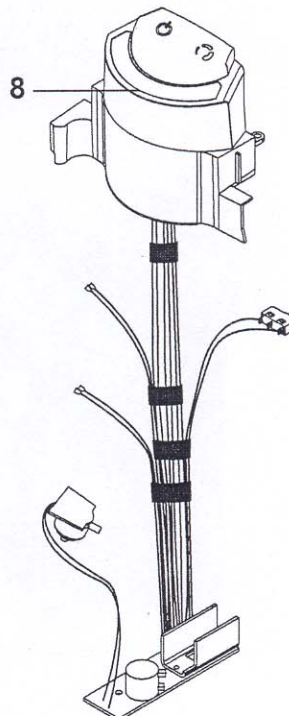
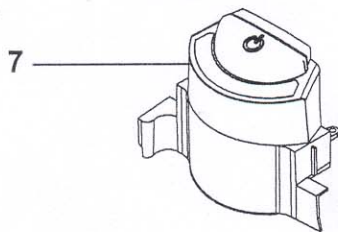
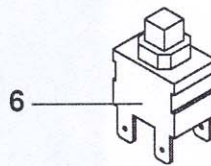
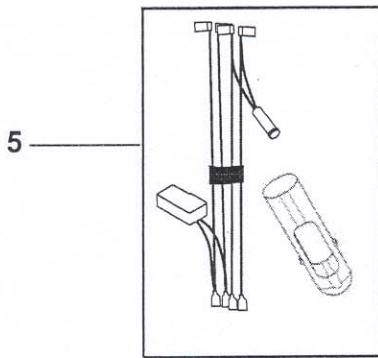
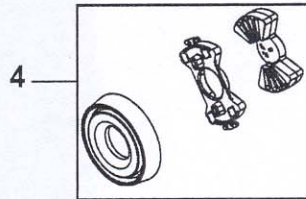
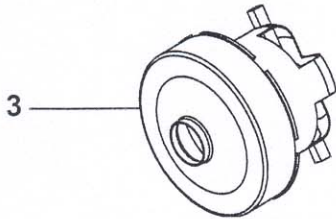
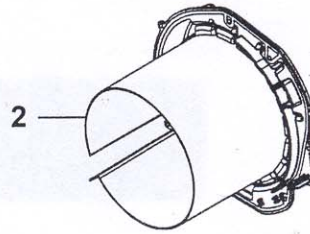
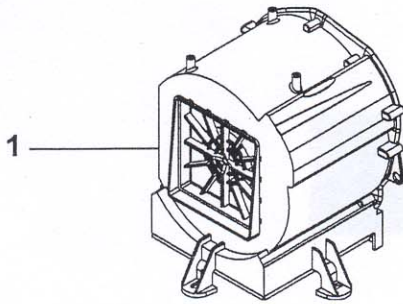

05-12	NILFISK EXTREME - SPARE PARTS AND SERVICE KITS	BOOK A		
07-02	MOTORS, ON/OFF SWITCHES, WIRES AND PCBs	A	5.6.3	3

Item	Part No.	Qty.	Description	Note	EAN code
1	147 0250 500	1	Motor module	Seal included	7319519647600
2	147 0251 500	1	Motor module lid	Seal included	7319519647617
3	147 0568 500	1	Motor	For Basic model, 220-240 V, 1200 W	7319519647624
3	147 0567 500	1	Motor	For Medium and Premium model, 220-240 V, 1600 W	7319519647631
3	147 0569 500	1	Motor	110-120 V, 1300 W	7319519647648
4	147 0560 500	1	Motor suspension kit		7319519647846
5>>	147 0554 500	1	Wire kit ON/OFF	For Basic model	7319519647839
6	140 8096 500	1	Switch kit	For Basic model	7319519629194
7	147 0120 500	1	Display ON/OFF version	For Basic model	7319519647815
8	147 0280 500	1	Electronics cpl., X150-210	220-240 V	7319519647778
8	147 0280 510	1	Electronics cpl., X150-210	110-120 V	7319519647785
9	147 0281 500	1	Electronics cpl., X300	220-240 V	7319519647792
9	147 0281 510	1	Electronics cpl., X300	110-120 V	7319519647808
10	140 7040 500	1	Internal wire for motor housing	220-240 V	7319519647655
10	140 7042 510	1	Internal wire for motor housing	110-120 V	7319519647662

Note

>> Means: New or changed part number or and changed specification.

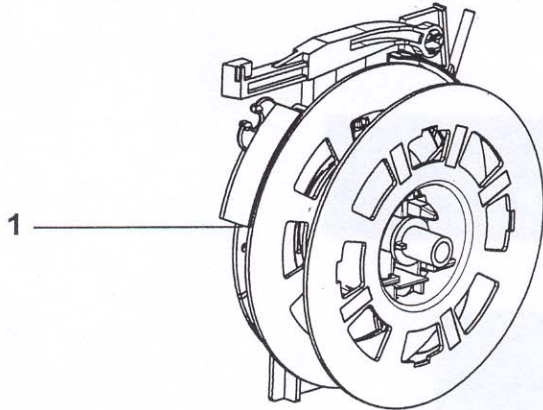

Cable with plug/socket for bracket			
	Voltage	Plug type	
EU	220-240		
UK	220-240		
AUS/NZ	220-240		
CH	220-240		
USA/CAN	110-120		

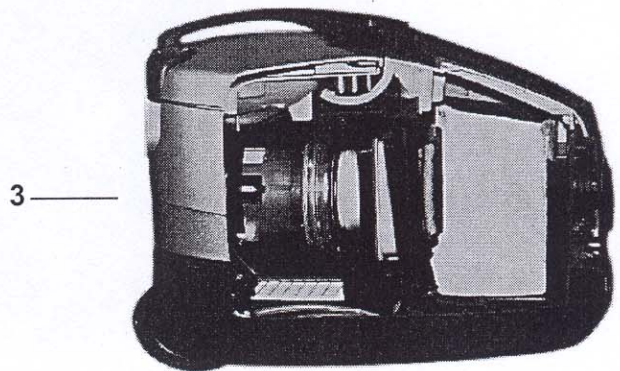
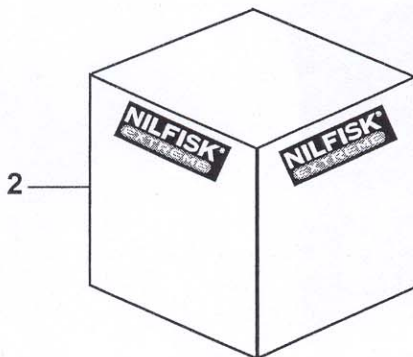

06-09	NILFISK EXTREME - SPARE PARTS AND SERVICE KITS	BOOK A		
07-02	CABLE SETS, MACHINE BOX AND CUT THROUGH MODEL	A	5.6.3	5

Item	Part No.	Qty.	Description	Note	EAN code
1	>>147 0182 550	1	Cable re-winder 8,5 m	EU	7319519660531
1	>>147 0182 560	1	Cable re-winder 8,5 m	UK	7319519660548
1	>>147 0182 570	1	Cable re-winder 8,5 m	AUS/NZ	7319519660555
1	>>147 0182 590	1	Cable re-winder 8,5 m	CH 8,5 m cable for X200, X210, X300	7319519660579
1	>>147 0171 550	1	Cable re-winder 7 m	EU	7319519660432
1	>>147 0171 560	1	Cable re-winder 7 m	UK	7319519660449
1	>>147 0171 570	1	Cable re-winder 7 m	AUS/NZ	7319519660456
1	>>147 0171 590	1	Cable re-winder 7 m	CH 7 m cable for X100 X110, X150	7319519660470
2	147 1147 000	1	Box, Extreme	New cardboard box, for the machine	7319519659573
3	147 0553 520	1	Cut Through model X 200	Complete machine	7319519659528

Note!

>> Means: New or changed part number or and changed specification

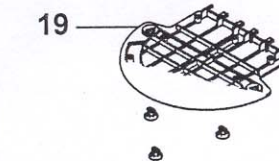
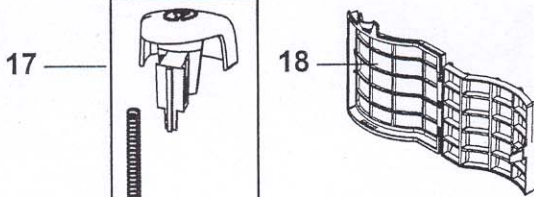
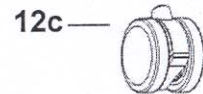
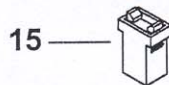
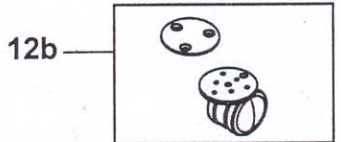
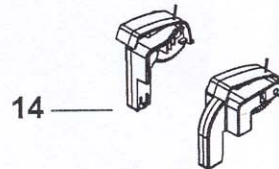
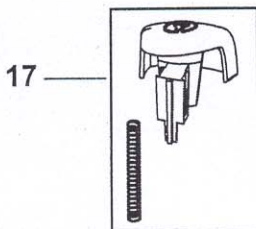
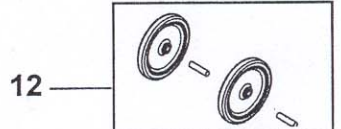
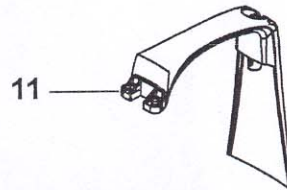
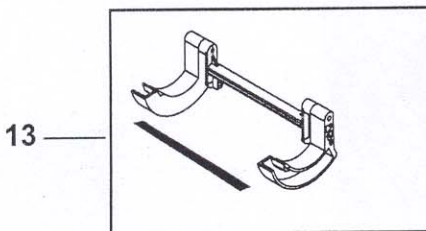
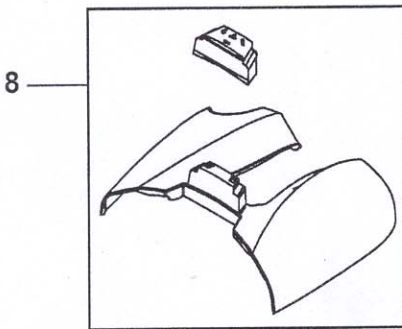
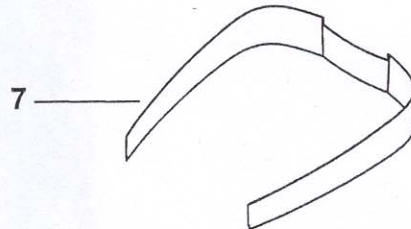
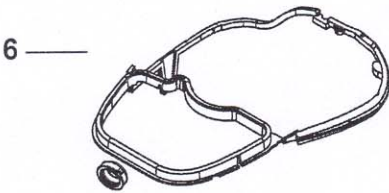
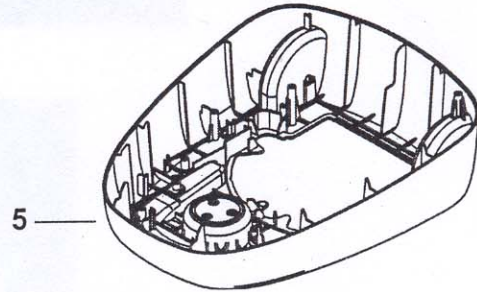
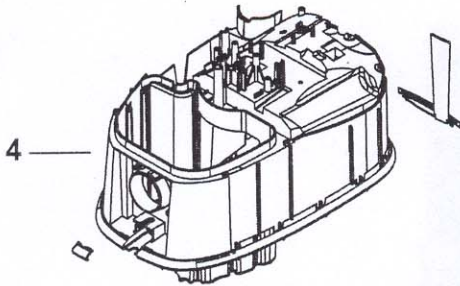
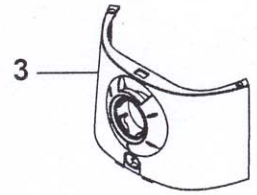
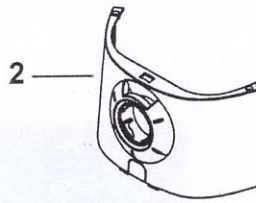
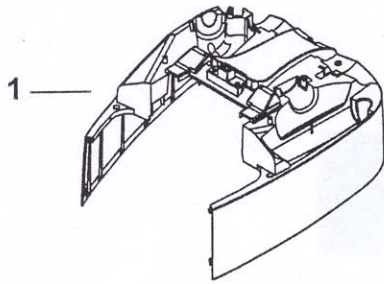

06-09	NILFISK EXTREME - SPARE PARTS AND SERVICE KITS	BOOK A		
07-01	BODY AND BODY PARTS	A	5.6.3	7

Item	Part No.	Qty.	Description	Note	EAN code
1	147 0113 500	1	Main body outer, X100	Coral Red	7319519647426
1	147 0113 510	1	Main body outer, X110	Sky Blue	7319519647433
1	147 0113 530	1	Main body outer, X150	Star Silver Metallic	7319519647440
1	147 0113 550	1	Main body outer, X200	Ice Blue Metallic	7319519647457
1	147 0113 570	1	Main body outer, X210	Purple Metallic	7319519647464
1	147 0113 580	1	Main body outer, X300	Champagne Metallic	7319519647471
2	147 0107 500	1	Cover front	For Basic and Medium model	7319519647495
3	147 0214 500	1	Cover front with power outlet	For Premium model	7319519647501
4	147 0215 500	1	Main body inner		7319519650303
5	147 0100 500	1	Body base	Black	7319519647587
6	147 0570 500	1	Sealing kit cpl.		7319519648027
7	147 0110 500	1	Personal cover	Silver Metallic	7319519647488
8	147 0116 510	1	Accessory lid, X100	Coral Red	7319519647525
8	147 0116 520	1	Accessory lid, X110	Sky Blue	7319519647532
8	147 0116 530	1	Accessory lid, X150	Star Silver Metallic	7319519647549
8	147 0116 540	1	Accessory lid, X200	Ice Blue Metallic	7319519647556
8	147 0116 550	1	Accessory lid, X210	Purple Metallic	7319519647563
8	147 0116 560	1	Accessory lid, X300	Champagne Metallic	7319519647570
9	147 0277 500	1	Dust lid cpl., X100	Coral Red	7319519647945
9	147 0277 510	1	Dust lid cpl., X110	Sky Blue	7319519647952
10	147 0298 500	1	Dust lid cpl., X150	Star Silver Metallic	7319519647969
10	147 0298 510	1	Dust lid cpl., X200	Ice Blue Metallic	7319519647976
10	147 0298 520	1	Dust lid cpl., X210	Purple Metallic	7319519647983
10	147 0298 530	1	Dust lid cpl., X300	Champagne Metallic	7319519647990
11	147 0212 500	1	Handle cpl.	Incl. print	7319519647938
12	147 0242 500	2	Wheel kit, incl. axles	2 rear wheels	7319519647594
12b	147 1040 500	1	Link wheel	With axle	7319519656329
12c	>>147 1040 510	1	Link wheel	Without axle	7319519660111
13	147 0264 500	1	Hinge, dust lid		7319519647884
14	147 0274 500	1	Hinge kit, accessory lid		7319519647891
15	147 0184 500	1	Lock, accessory lid		7319519647907
16	147 0108 500	1	Button, dust lid		7319519647914
17	147 0117 500	1	Button, cable re-winder		7319519647921
18	P 147 0158 500	1	Holder, pre-filter		7319519648003
18	>>147 1187 500	1	Holder, pre-filter	More ribs added	7319519662016
19	147 0101 500	1	Hepa lid		7319519648010
20	147 0208 500	1	Parking plate		7319519647822

Note >> Means: New or changed part number or and changed specification.
P Means: Depleted when no longer on stock, replaced by 147 1187 500.

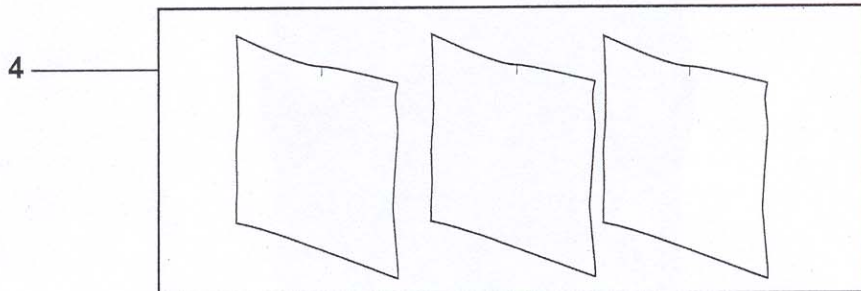
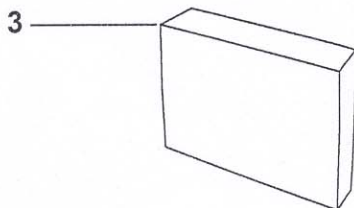
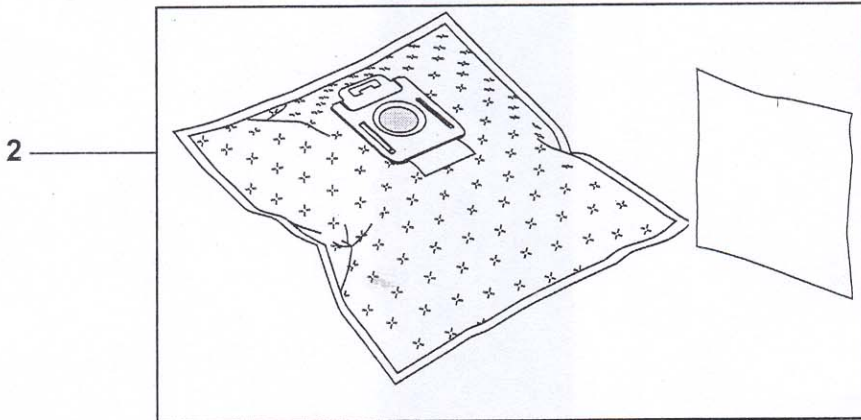
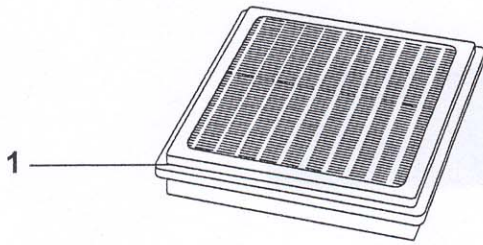

05-02	NILFISK EXTREME - SPARE PARTS AND SERVICE KITS	BOOK A		
	DUST BAGS AND FILTERS	A	5.6.3	9

Item	Part No.	Qty.	Description	Note	EAN code
1	147 0180 500	1	Hepa filter H14	141x132 mm	7319519645194
2	147 0286 500	1	Dust bags and pre-filters	4 fabric plus bags, 1 pre-filter Extreme, 1 pre-filter King	7319519645644
3	147 0159 500	1	Active carbon filter	106x106 mm	7319519647389
4	147 0157 500	1	Pre-filters	3 pcs	7319519647396

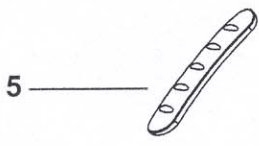
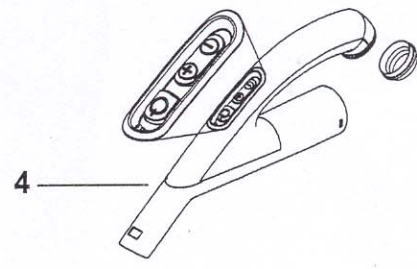
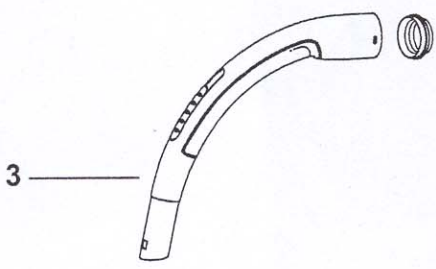
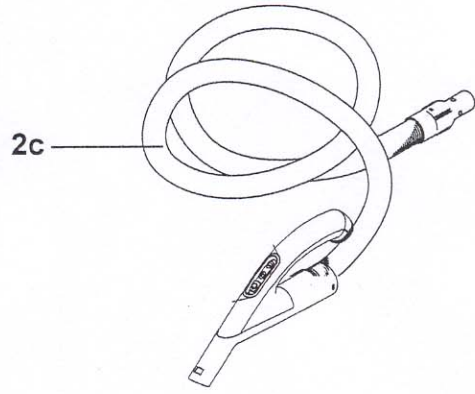
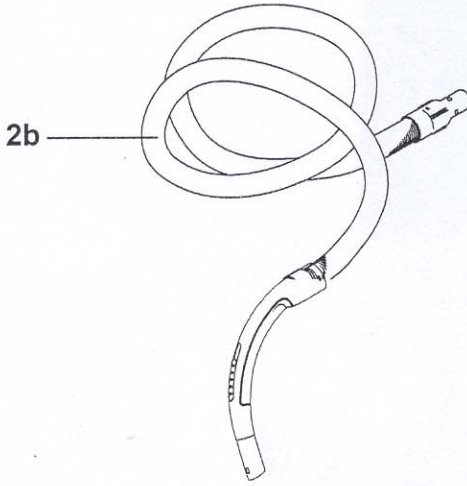
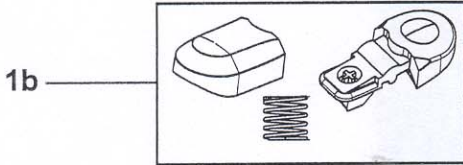
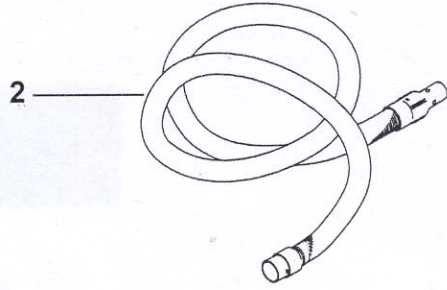
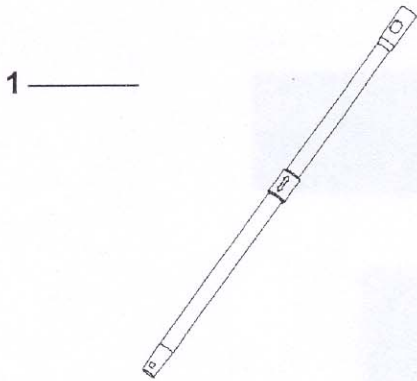

06-06	NILFISK EXTREME - SPARE PARTS AND SERVICE KITS	BOOK A		
07-02	HOSES, CONNECTIONS AND TUBES	A	5.6.3	11

Item	Part No.	Qty.	Description	Note	EAN code
1	147 0284 500	1	Telescopic tube	32x1045 mm, Crome	7319519647327
1	147 0284 510	1	Telescopic tube	32x1045 mm, Aluminium	7319519647334
1b >>	147 0265 500	1	Button and cover click fit.	Spring included	7319519659412
2	147 0285 500	1	Hose with coupling	D 32/38 mm, L 2000 mm	7319519647341
2b	147 0283 500	1	Hose cpl. with Bent End Basic.	For Basic and Medium model, D 32 mm	7319519659122
2c	147 0577 500	1	Hose cpl. with Bent End Premium.	For Premium model, D 32 mm,	7319519659115
3 >>	147 0243 520	1	Bent end	For Basic and Medium model, D 32 mm	7319519659146
4 P	147 0123 500	1	Bent end incl. speed regulator	For Premium model, D 32 mm, Battery type CR2032	7319519647877
4 >>	147 0123 520	1	Bent end incl. speed regulator	For Premium model, D 32 mm, Battery type CR2032	7319519659139
5	147 0152 500	1	Valve, bent end	For Basic and Medium model, 5 pcs	7319519647860
6	147 0283 500	1	Hose cpl. w bent end	For Basic	7319519659412

Note!

>> Means: New or changed part number or and changed specification.

P Means: Depleted when no longer on stock. Replaced by 147 0123 520.

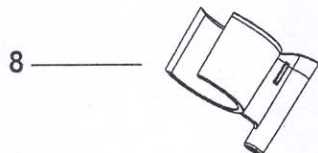
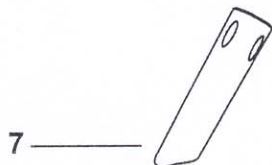
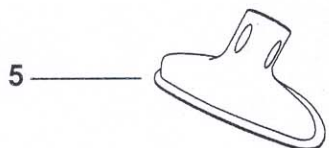
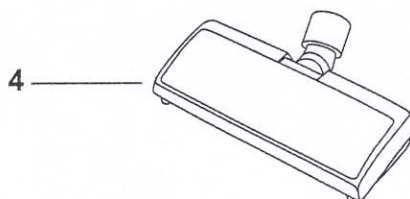
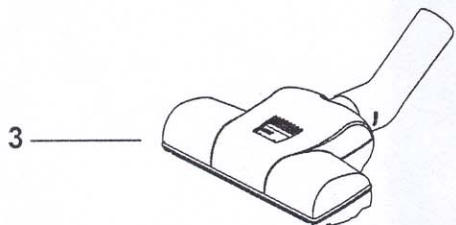
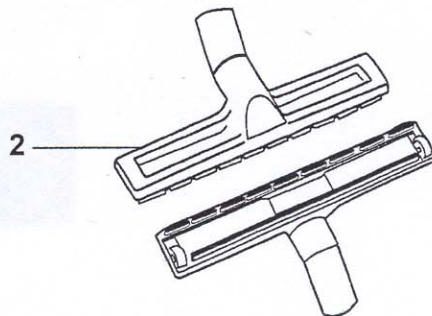
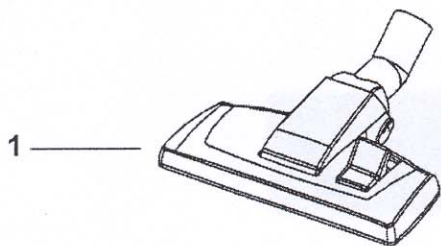

06-02	NILFISK EXTREME - SPARE PARTS AND SERVICE KITS	BOOK A		
06-10	NOZZLES	A	5.6.3	13

Item	Part No.	Qty.	Description	Note	EAN code
1	140 8492 520	1	Combi nozzle	D 32 mm, Black	7319519636673
2	140 6700 540	1	Hard floor nozzle	D 32 mm, Black	7319519636680
3	22360000	1	Turbo nozzle	D 32 mm, W 300 mm, Black	5715492010882
4	12010100	1	Electro nozzle	220-240 V	7319519600643
5	147 0299 500	1	Upholstery nozzle	D 32 mm, W 142 mm, Black	7319519647365
6	147 0300 500	1	Triangular nozzle	D 32 mm, Black	7319519647372
7	147 0146 500	1	Crevice nozzle	D 32 mm, L 153 mm, Black	7319519647358
8	>>12018201	1	Parking clip	Clip for combi nozzle and hard floor nozzle. Black.	5715492028627

Note!

>> Means: New or changed part number or and changed specification.