

DAEWOO

Service manual

Model name: ERF-368MBW, ERF-368MBI, ERF-368MBB,
ERF-388MBW, ERF-388MBI, ERF-388MBB, ERF-387MH_E, ERF-387MS_E



. CONTENTS

- 1. SPECIFICATIONS**
- 2. EXTERNAL DRAWINGS**

- 3. MACHINE ROOM VIEW**
- 4. REFRIGERANT CYCLE**
- 5. WIRING DIAGRAM**
- 6. COMPONENTS DISASSEMBLY PICTURES**
- 7. DOOR POSITION CHANGE PROCESS**
- 8. EXPLODE DRAWING**
- 9. PARTS LIST**

1. SPECIFICATIONS

Technical name		368/7	388/7	398/7	418/7
Division		MECHANIC TYPE			
Refrigerant type		R-134A			
Refrigerant Q'ty		100 grs			
Blowing agent		C-PENTANE			
Cooling system		Fan cooling system			
Defrost system		Automatic start & Automatic stop system			
Compressor		KPC CBE-140L5Z			
Rated voltage		AC220~240V / 50Hz			
Rated input (W)		180			
Lamp rated input (W)		15			
Gross capacity (liter)	Freezer	94	109	94	109
	Refrigerator	218	218	252	252
	Total	312	327	346	361
External dimension (mm)	Height	1765	1854	1896	1985
	Width	600	600	600	600
	Depth *	642	642	642	642
Energy class		A			
Freezing capacity(kg/24h)		5			
Star rating		* ***	* ***	* ***	* ***
Climate class		N	N	N	N
Net weight (kg)		69	71	71	74

REMARKS:

* Dept exception handle

1.2. Types of the approved safety standars



2. EXTERNAL DRAWINGS

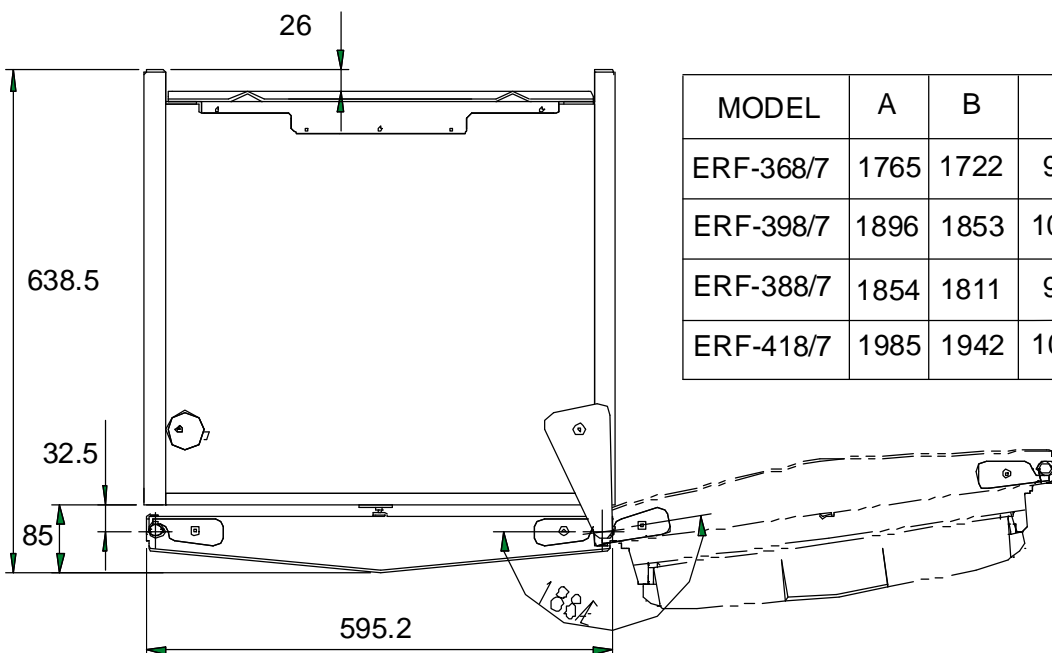
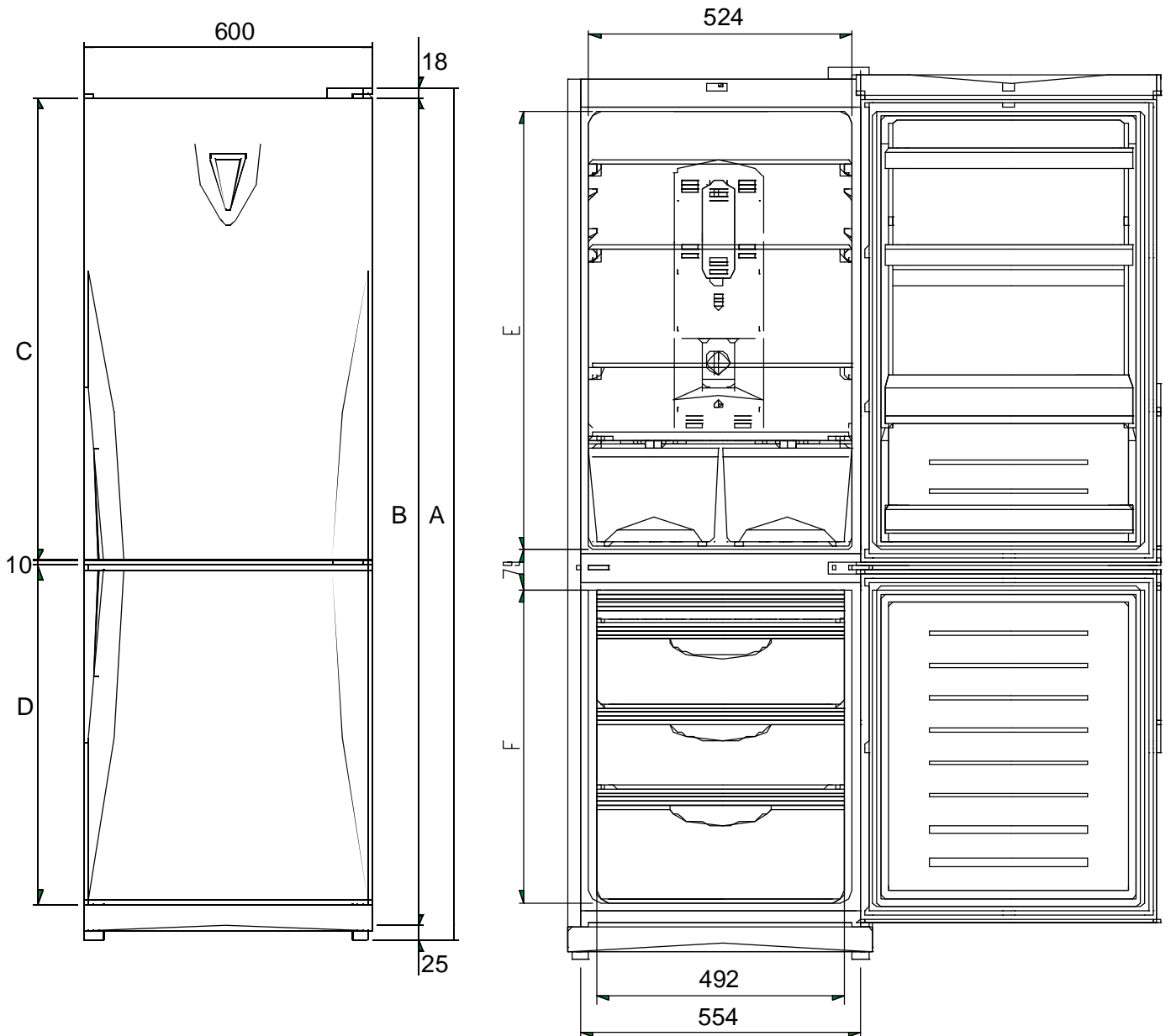

MODEL	A	B	C	D	E	F
ERF-368/7	1765	1722	967	698	862.5	621.5
ERF-398/7	1896	1853	1098	698	993.5	621.5
ERF-388/7	1854	1811	967	787	862.5	710.5
ERF-418/7	1985	1942	1098	787	993.5	710.5

3. MACHINE ROOM VIEW

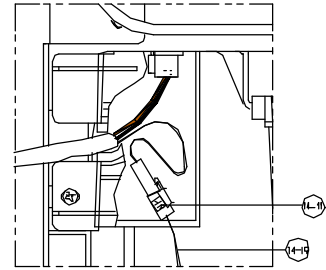

DETAIL 3X

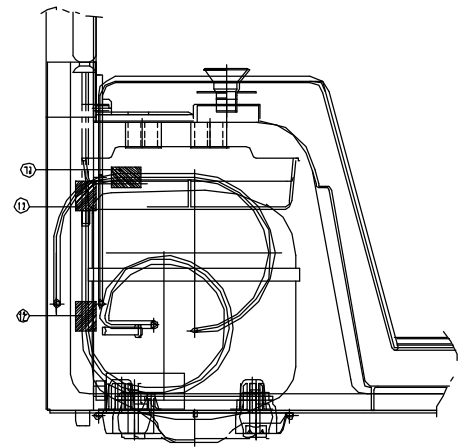
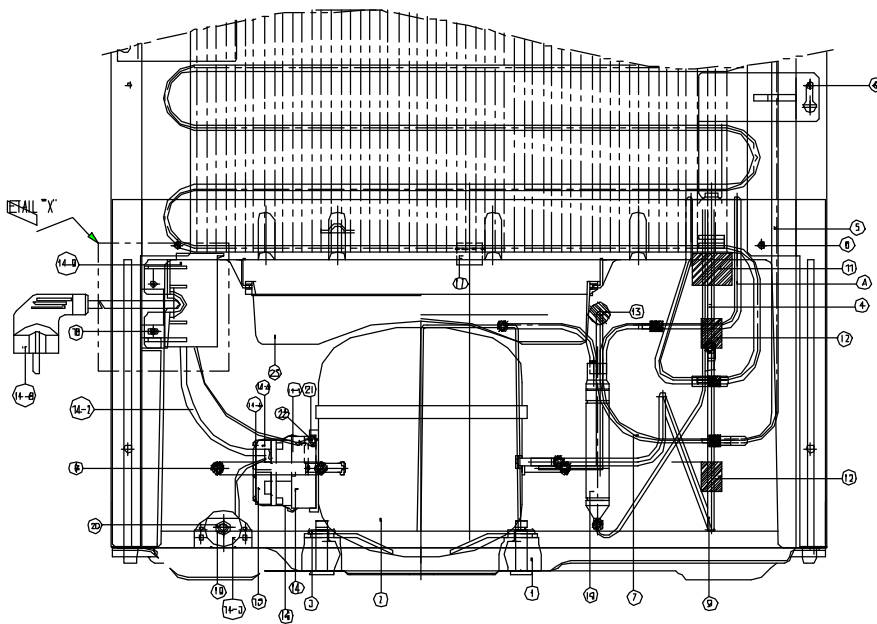

No.	PART NAME	No.	PART NAME	No.	PART NAME
A	PIPE HOT	14	BOX RELAY AS	17	CAP DRAINER
1	ABSORBER COMP	14-1	BOX RELAY	18	SCREW TAPPING
2	COMPRESSOR	14-2	HARNESS RELAY	19	SPECIAL WASHER R/C
3	FIXTURE COMP	14-3	CAPACITQR RUN AS	20	SPECIAL NUT R/C
4	EVAPORATOR AS	14-4	CABLE CLAMP	21	SPECIAL WASHER
5	PIPE WI-COON AS	14-5	SCREW TAPPING	22	SCREW MACHINE
6	SPECIAL SCREW E	14-6	SWITCH P RELAY PTC	23	CASE VAPORI
7	PIPE COON B	14-7	SWITCH P RELAY OL		
8	PIPE CHARGE	14-8	CODE POWER AS		
9	PIPE SUC. COON	14-9	COVER ME HOUSING		
10	DRYER AS	14-10	HARNESS EARTH		
11	ABSORBER PIPE B (GUM)	14-11	LABEL EARTH		
12	ABSORBER PIPE C (40g)	15	RELAY COVER		
13	ABSORBER PIPE C (38g)	16	BAND RELAY		

4. REFRIGERANT CYCLE

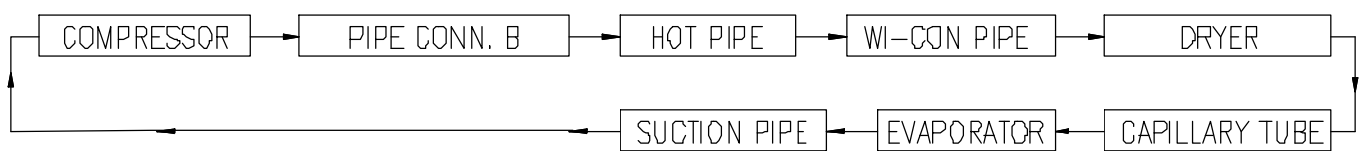
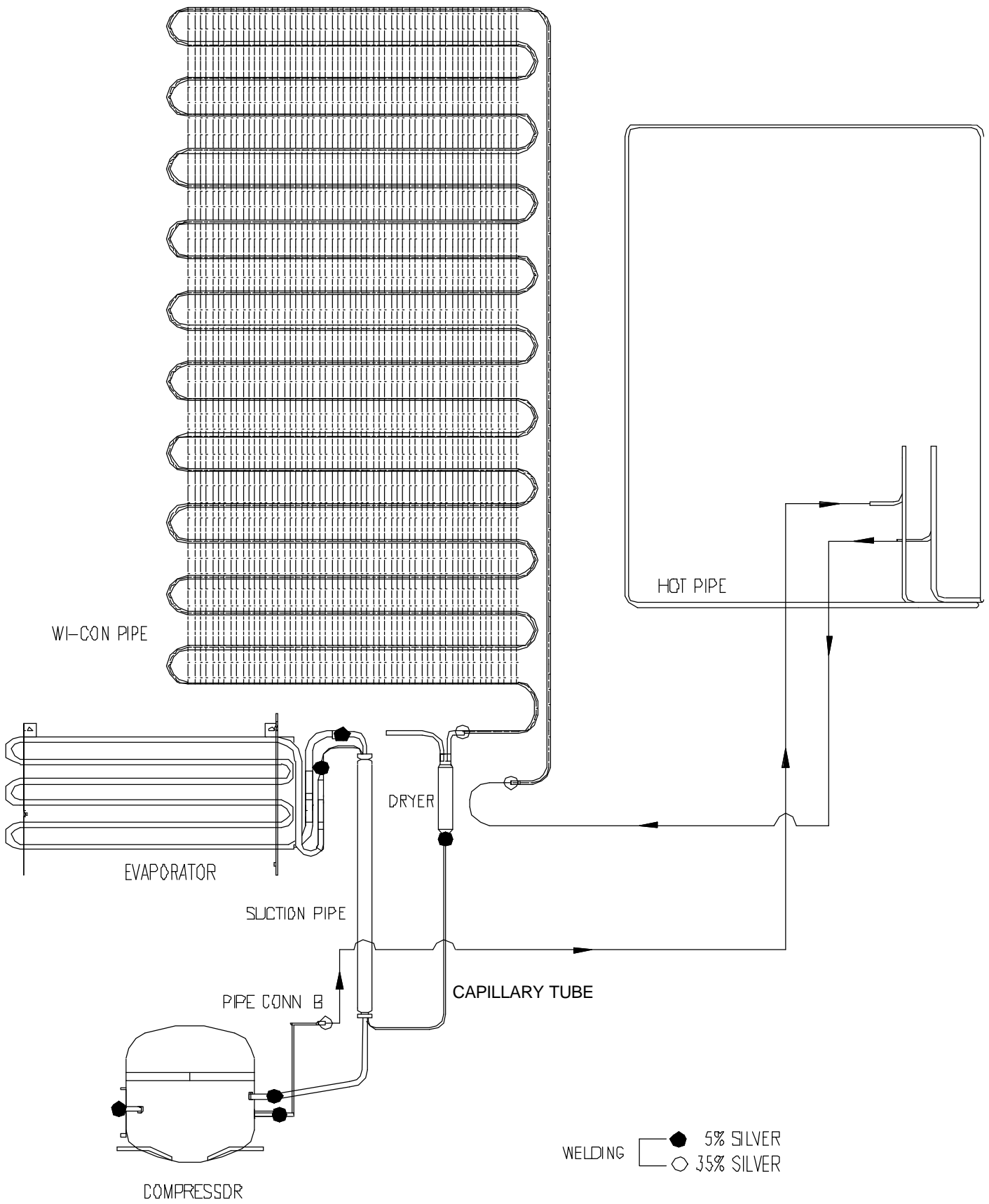

5. WIRING DIAGRAM

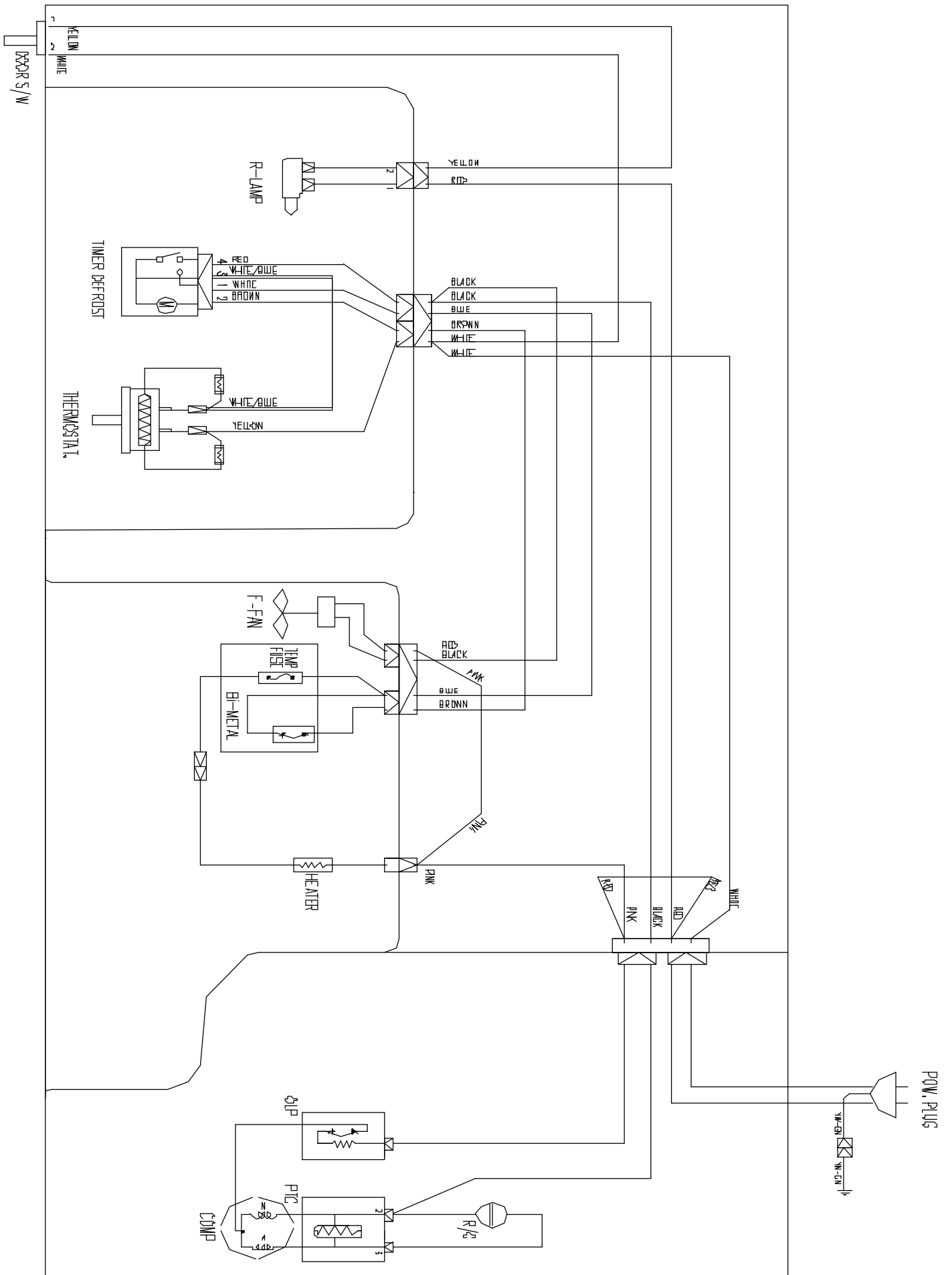

6. COMPONENTS DISASSEMBLY PICTURES

- SWITCH DOOR

- Force switch door to the left side and input a thin driver in the right part as picture shows. After this operation, lift switch up.

* Remark: Input driver carefully in order to lift up easily and avoid paint damages and scratches.

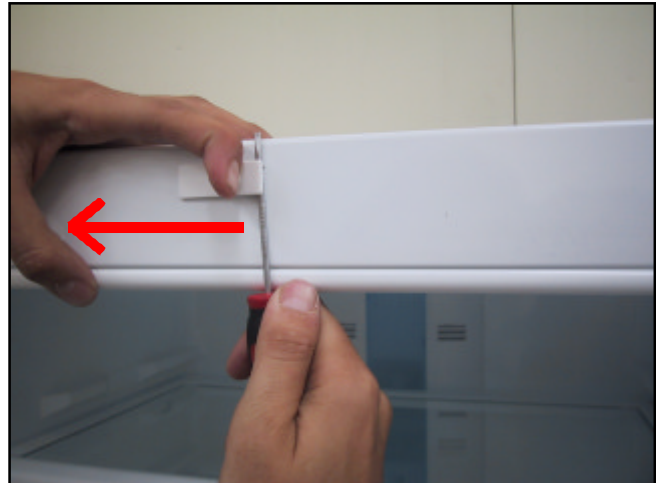

- move switch to left side.

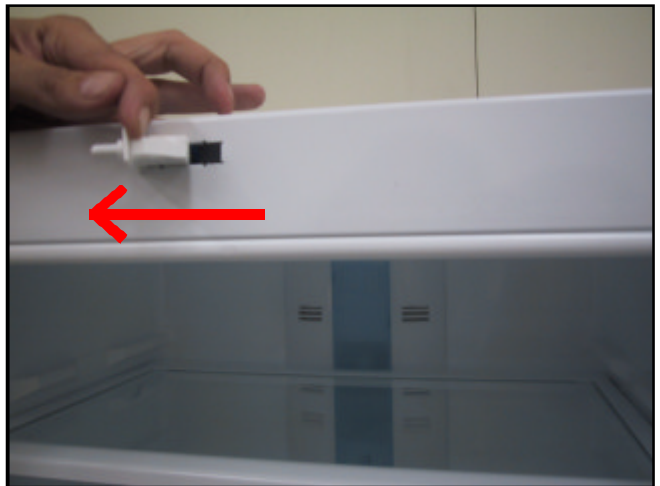

- Take out switch and disconnect housing.



- MULTI DUCT

- Unscrew all fixed screws.



- Remove insulator multi-duct.

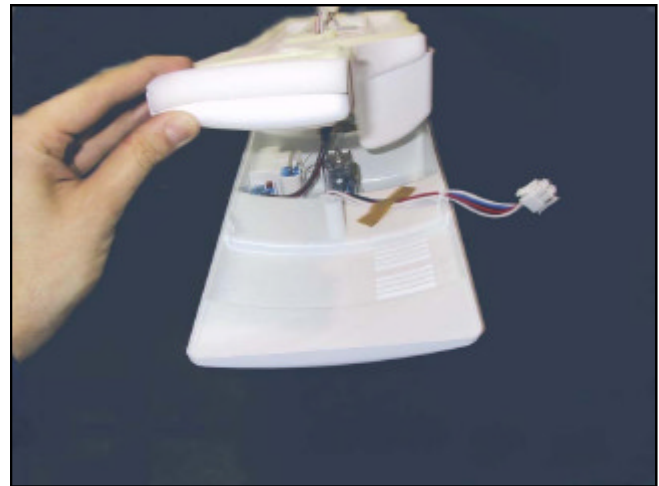

- Unscrew defrost timer and thermostat.



- Take out temperature control knob by a minus driver carefully.

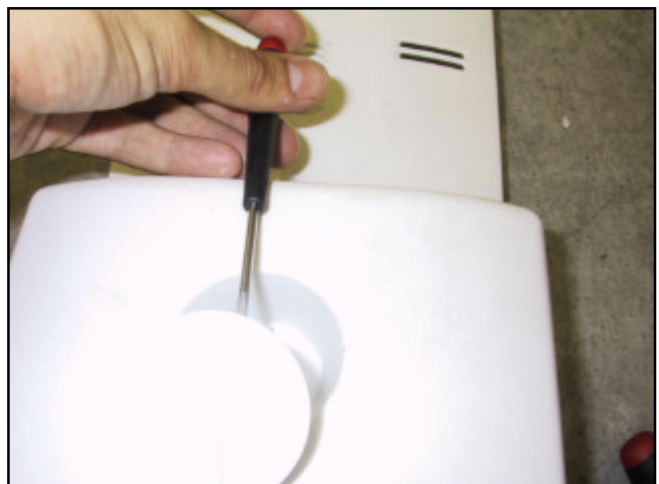

- LOUVERS:

- Unscrew the two fixing screw for diassembly louver A and B



- Disconnect fan motor housing



- Unscrew the fixing screw in order to disassemble Louver A.



- When louvers are disassembled is very important check Knob F louver position.

Default position is M

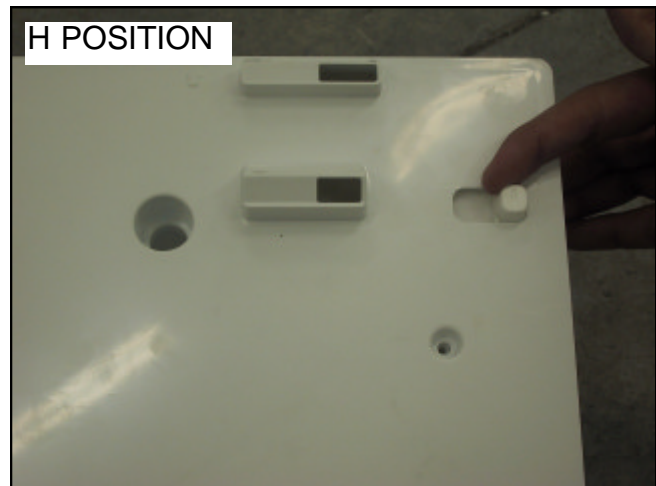
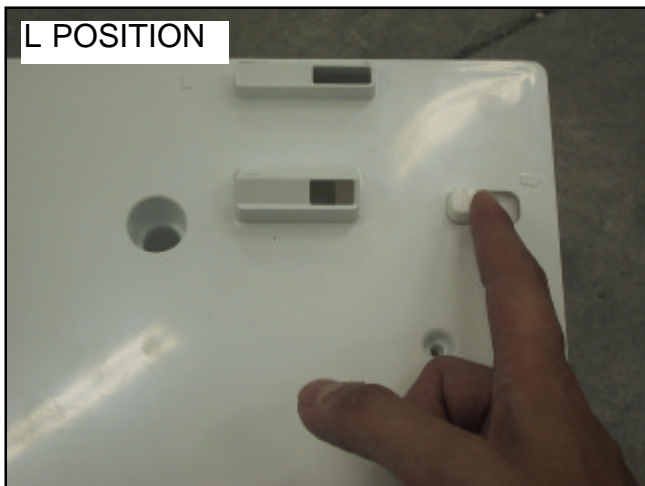
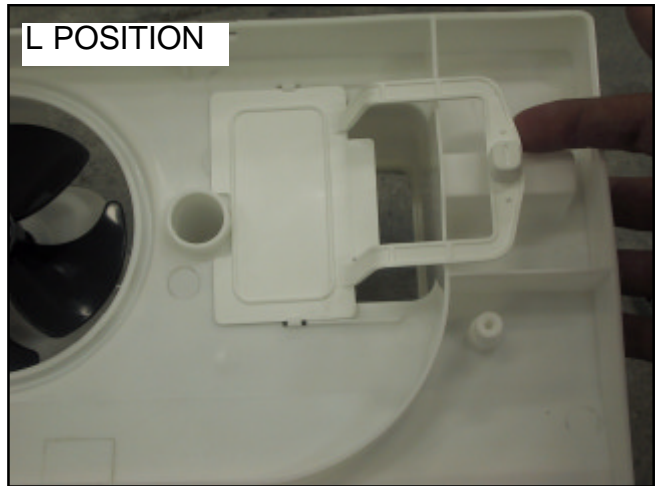

-CHANGE DOOR OPEN SIDE

- Unscrew cover T hinge

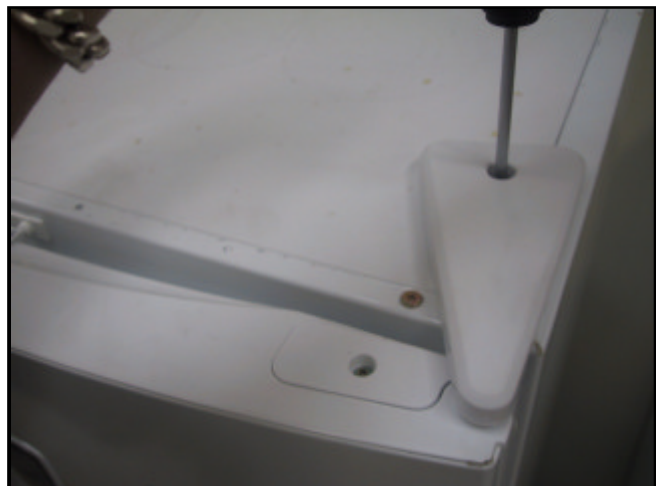

Follow next sheets instructions to change door open side

7. DOOR POSITION CHANGE PROCESS

STEP 1 : Remove door

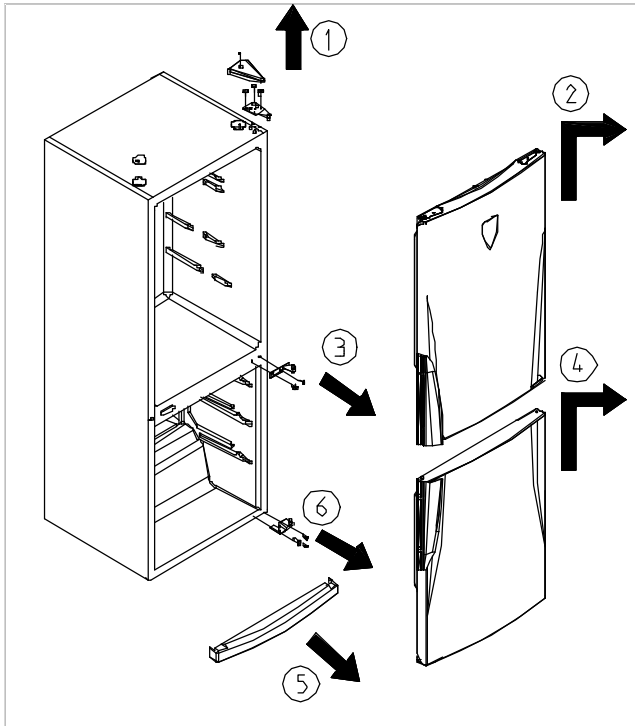

Follow to remove

1. Remove "COVER HINGE" and "HINGE T"
2. Remove "R" door.
3. Remove "HINGE M"
4. Remove "F" door
5. Remove "COVER BRACKET"
6. Remove "HINGE U"

STEP 2 : Change door handle

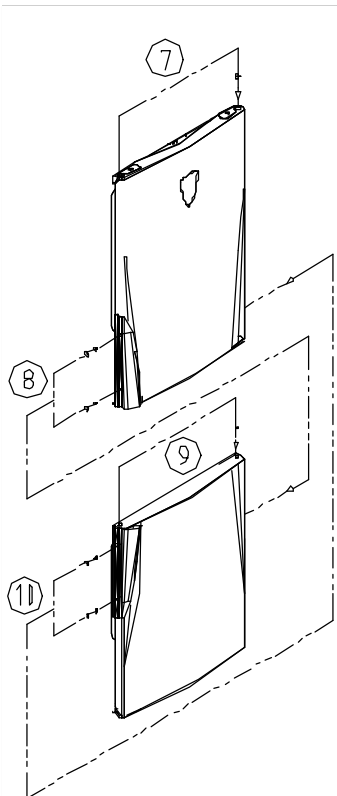

7. Reverse the position of "COVER BUSHING"
8. Move "R DOOR HANDLE" to "F DOOR"
9. Reverse the position of "CAP DR BUSHING"
10. Move "F DOOR HANDLE" to "R DOOR"

STEP 3 : Change door open side

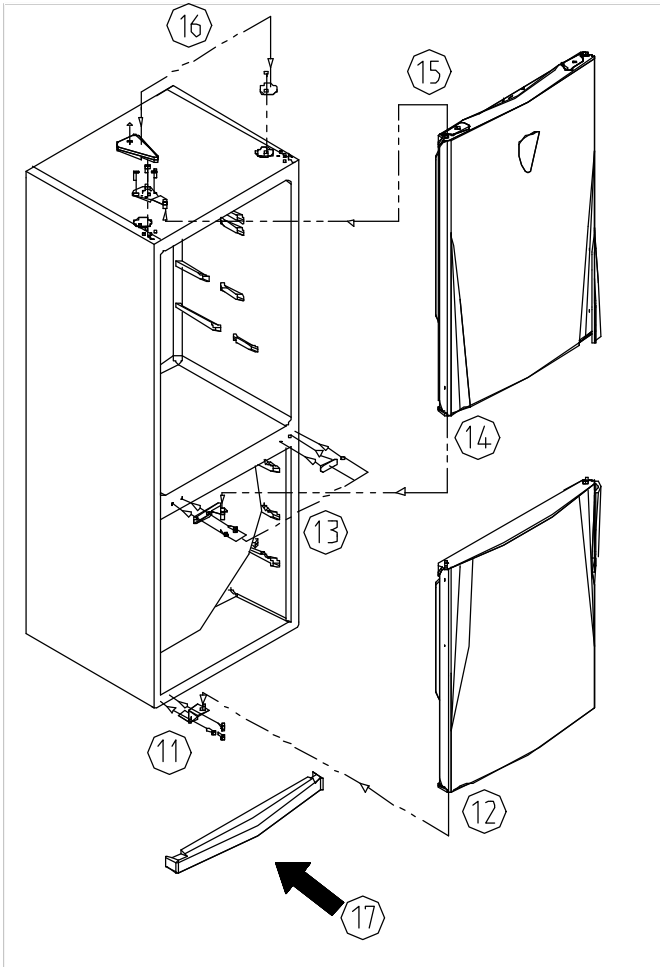

11. Attach the "HINGE U" on the left.

12. Attach the "F DOOR"

13. Reverse the position of "HINGE M" and
"CAP SCREW HOLE"

1. Attach the "R DOOR"

15. Attach the "HINGE T" on the left
of cabinet
after assembling to "R DOOR"

16. Reverse the position of "COVER
HINGE"
and "COVER CAB HARNESS"

EXPLODE DRAWING

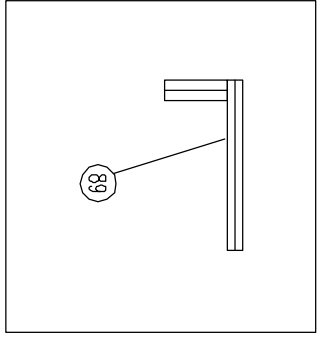
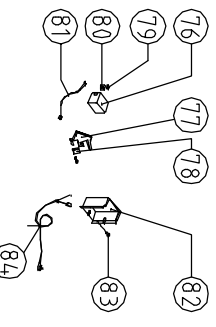
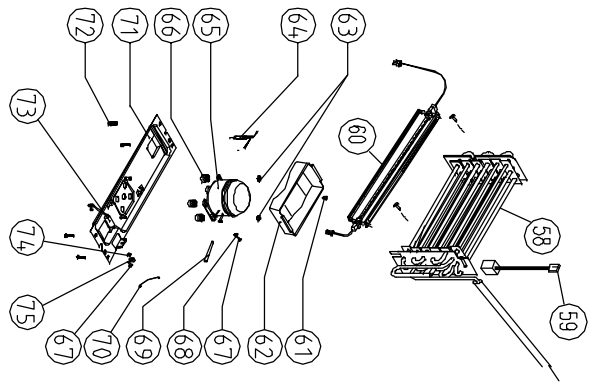
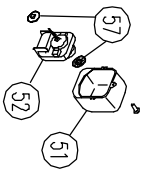
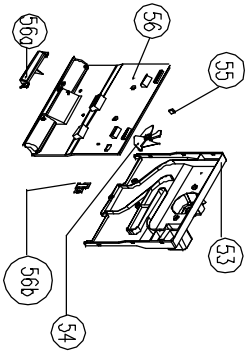
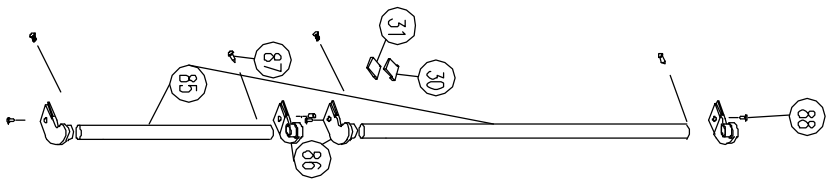
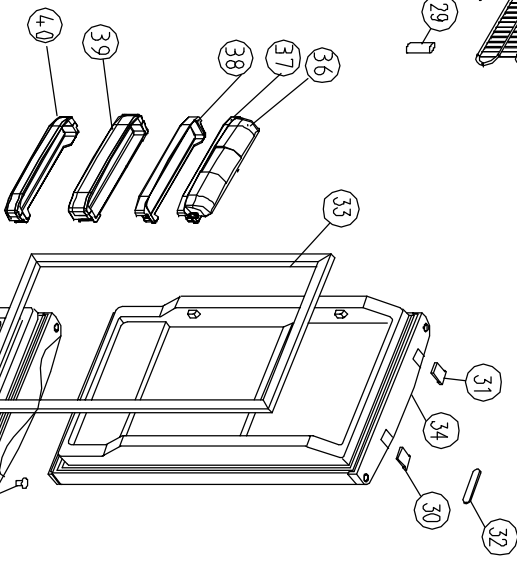
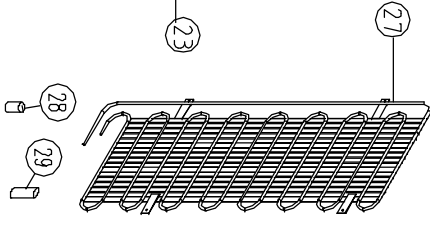
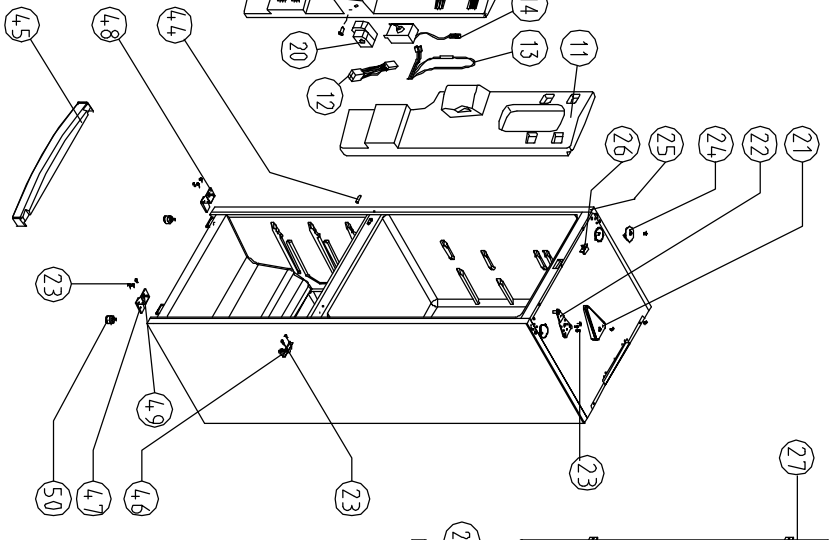
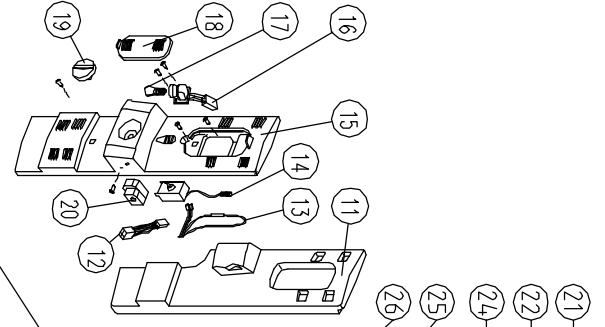
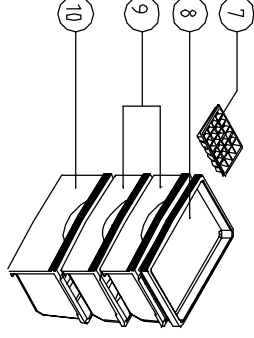
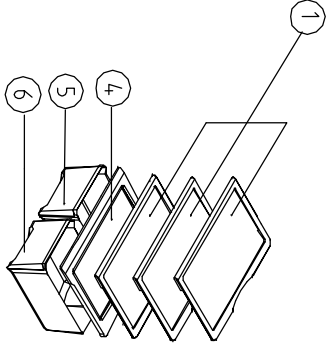
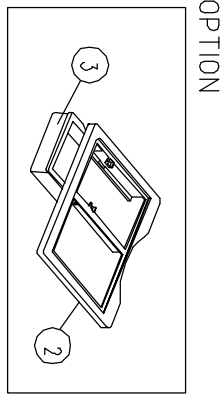

Part list

EXPLODE DRAWING N°	PART CODE	PART NAME	COLOUR	HANDLE TYPE	ERF-368MBW (ERF-366MNL)	ERF-368MBI (ERF-366MNL)	ERF-368MBB (ERF-366MNL)	ERF-388MBW (ERF-386MNL)	ERF-388MBI (ERF-386MNL)	ERF-388MBB (ERF-386MNL)	ERF-387MH_E (ERF-386MNL)	ERF-387MS_E (ERF-386MNL)
1	3017839400	GLASS SHELF (INSERT TYPE) '04			3	3	3	3	3	3	3	3
2	DMS2202801	COVER CHILLED CASE ASSY (GLASS)			-	-	-	-	-	-	-	-
3	DMS1163370	CASE CHILLED SMALL BLUE MILKY	BLUE MILKY		-	-	-	-	-	-	-	-
4	3001402200	COVER GLASS V/CASE (INSERT TYPE) ERF**4			1	1	1	1	1	1	1	1
5	DMS1181910	CASE VEGETABLE *L '04 BLUE MILKY 2006	BLUE MILKY		1	1	1	1	1	1	1	1
6	DMS1182010	CASE VEGETABLE *R '04 BLUE MILKY 2006	BLUE MILKY		1	1	1	1	1	1	1	1
7	3011163200	CASE ICING 2000			1	1	1	1	1	1	1	1
8	3011181800	CASE F D 04			1	1	1	1	1	1	1	1
9	DMS1184910	CASE FB AS			2	2	2	-	-	-	-	-
9	DMS1185010	CASE F C AS			-	-	-	2	2	2	2	2
10	3011184800	CASE F A AS			1	1	1	1	1	1	1	1
11	3013337100	INSULATOR MULTI DUCT M 36../38../40			1	1	1	1	1	1	1	1
12	3012756600	HARNESS THERMO-TIMER A			1	1	1	1	1	1	1	1
13	3012756610	HARNESS THERMO-TIMER B			1	1	1	1	1	1	1	1
14	3018120910	THERMOSTAT GNF-176DB (OFF POSITION)			1	1	1	1	1	1	1	1
15	DMS1452040	COVER MULTI DUCT 36../38../40.. (OFF POSITION)			1	1	1	1	1	1	1	1
16	3017903900	SOCKET R LAMP AS			1	1	1	1	1	1	1	1
17	3013600700	LAMP 220V 15W			1	1	1	1	1	1	1	1
18	3015503300	WINDOW LAMP MILKY COMMON			1	1	1	1	1	1	1	1
19	3013401410	KNOB R			1	1	1	1	1	1	1	1
20	3018128310	SWITCH D TIMER (INVENSYS) CF-3001-21			1	1	1	1	1	1	1	1
21	DMS1494310	COVER *T HINGE SNOW WHITE	WHITE		1	-	-	1	-	-	1	-
21	DMS1494340	COVER *T HINGE (N/G)	NOBLE GREY		-	1	-	-	1	-	-	1
21	DMS1494330	COVER *T HINGE (BLACK)	BLACK		-	-	1	-	-	1	-	-
22	3012922600	HINGE *T AS			1	1	1	1	1	1	1	1
23	3016004900	SPECIAL BOLT C			9	9	9	9	9	9	9	9
24	DMS1477510	COVER CAB HARNESS SNOW WHITE	WHITE		1	-	-	1	-	-	1	-
24	DMS1477540	COVER CAB HARNESS NOBLE GREY	NOBLE GREY		-	1	-	-	1	-	-	1
24	DMS1477530	COVER CAB HARNESS (BLACK)	BLACK		-	-	1	-	-	1	-	-
25	-	ASSY CAB URT 366M			1	1	1	-	-	-	-	-
25	-	ASSY CAB URT 386M			-	-	-	1	1	1	1	1
26	3011755200	SWITCH DOOR SNOW WHITE	WHITE		1	-	-	1	-	-	1	-
26	3011783400	SWITCH DOOR NOBLE GREY	NOBLE GREY		-	1	-	-	1	-	-	1
26	3011782900	SWITCH DOOR (BLACK)	BLACK		-	-	1	-	-	1	-	-
27	3014434501	PIPE WI-CON AS			1	1	1	1	1	1	1	1
28	4016C08014	ABSORBER PIPE C EXTRUSION 20gr			1	1	1	1	1	1	1	1
29	DMS7792302	SEALING DIVISION			1	1	1	1	1	1	1	1
30	DMS1467390	COVER DOOR CAP *L BAR HANDLE (SNOW WHITE)	WHITE		1	-	-	1	-	-	1	-
30	DMS1467360	COVER DOOR CAP *L BAR HANDLE (NOBLE GREY)	NOBLE GREY		-	1	-	-	1	-	-	1
30	DMS1467370	COVER DOOR CAP *L BAR HANDLE (BLACK)	BLACK		-	-	1	-	-	1	-	-
31	DMS1467490	COVER DOOR CAP *R BAR HANDLE (SNOW WHITE)	WHITE		1	-	-	1	-	-	1	-
31	DMS1467460	COVER DOOR CAP *R BAR HANDLE (NOBLE GREY)	NOBLE GREY		-	1	-	-	1	-	-	1
31	DMS1467470	COVER DOOR CAP *R BAR HANDLE (BLACK)	BLACK		-	-	1	-	-	1	-	-
32	3013595400	EMBLEM DAEWOO '04 (CHROME)			1	1	1	1	1	1	1	1
33	3012306600	GASKET R DR 36./38. WHITE			1	1	-	1	1	-	1	1
33	DMS2306630	GASKET R DR 36./38. GRAY COLOR	DARK GREY		-	-	1	-	-	1	-	-
34	DMS0085580	R DOOR BAR (SNOW WHITE) 384NBW (BAR H.D2)	SNOW WHITE	BAR HNDL	1	-	-	1	-	-	-	-
34	DMS0085560	R DOOR BAR (INOX 08) 364MBI, 364MBT (BAR H.D2)	INOX 08	BAR HNDL	-	1	-	-	1	-	-	-
34	DMS0080845	R DOOR BAR BLACK 366 (BAR H.D2)	BLACK	BAR HNDL	-	-	1	-	-	1	-	-
34	DMS0085950	R DOOR HIDDEN (SNOW WHITE) 366M, 386M - HIDDEN H.	SNOW WHITE	HIDDEN	-	-	-	-	-	-	1	-
34	DMS0085550	R DOOR HIDDEN (INOX 08) 366M 386M HIDDEN D2	INOX 08	HIDDEN	-	-	-	-	-	-	-	1
35	3010967400	CAP DOOR BUSHING (SNOW WHITE)	WHITE		1	-	-	1	-	-	1	-
35	DMS0967410	CAP DOOR BUSHING (DARK GRAY)	DARK GREY		-	1	1	-	1	1	-	1
36	3011495000	COVER DAIRY POCKET			1	1	1	1	1	1	1	1
37	3019025000	POCKET DAIRY			1	1	1	1	1	1	1	1
38	3019025200	POCKET R 04			1	1	1	1	1	1	1	1
39	DMS9026110	POCKET BOTL AS			1	1	1	1	1	1	1	1
40	3019026200	POCKET MULTI AS			1	1	1	1	1	1	1	1
41	DMS0057570	F DOOR BAR (SNOW WHITE) 364NBW (BAR H.D2)	SNOW WHITE	BAR HNDL	1	-	-	-	-	-	-	-
41	DMS0085590	F DOOR BAR (SNOW WHITE) 384NBW (BAR H.D2)	SNOW WHITE	BAR HNDL	-	-	-	1	-	-	-	-
41	DMS0087490	F DOOR BAR (INOX 08) 364MBI, 364MBT, 364MBIT (BAR H. D2)	INOX 08	BAR HNDL	-	1	-	-	-	-	-	-
41	DMS0085570	F DOOR BAR (INOX 08) 384MBI, 384MBT, 384MBIT (BAR H. D2)	INOX 08	BAR HNDL	-	-	-	-	1	-	-	-
41	DMS0057650	F DOOR BAR (BLACK) 366 (BAR H. D2)	BLACK	BAR HNDL	-	-	1	-	-	-	-	-
41	DMS0057620	F DOOR BAR (BLACK) 386 (BAR H. D2)	BLACK	BAR HNDL	-	-	-	-	-	1	-	-
41	DMS0086770	F DOOR HIDDEN (SNOW WHITE) 384, 386M	SNOW WHITE	HIDDEN	-	-	-	-	-	-	1	-
41	DMS0085540	F DOOR HIDDEN (INOX 08) 384, 386M	INOX 08	HIDDEN	-	-	-	-	-	-	-	1
42	3012306500	GASKET F DR 36./39. WHITE			1	1	-	-	-	-	-	-
42	DMS2306530	GASKET F DR 36./39. GRAY COLOR	DARK GREY		-	-	1	-	-	-	-	-
42	3012306700	GASKET F DR 38./41. WHITE			-	-	-	1	-	-	1	1
42	DMS2306730	GASKET F DR 38./41. GRAY GE COLOR	DARK GREY		-	-	-	-	-	1	-	-



DAEWOO ELECTRONICS MANUFACTURING ESPAÑA S.A
Polígono industrial de Jándiz
C/Zurupitieta 27, 01015 Vitoria, Spain

Tel: 00 34 945292292
Fax:00 34 945290965