

WASHING MACHINE

INSTRUCTION BOOKLET

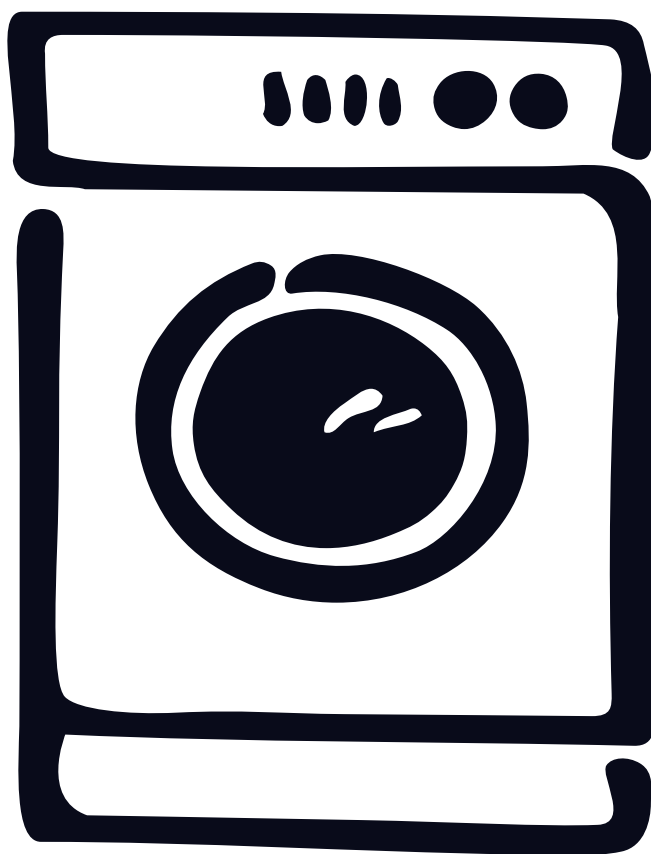

EWF 890

Dear customer,

Please read these operating instructions carefully and pay particular attention to the safety notes indicated in the first pages. We recommend that you keep this instruction booklet for future reference and pass it on to any future owners.

Transport damages

When unpacking the appliance, check that it is not damaged. If in doubt, do not use it and contact the Service Centre.

The symbols you will see on some paragraphs of this booklet have the following meaning:



The warning triangle and/or the key words (Warning!, Caution!) emphasize information that is particularly important for your safety or correct functioning of the appliance.



The information marked with this symbol provides additional instructions and practical tips on the use of the appliance.



Tips and information about economical and ecological use of the machine are marked with this symbol.

Our contribution to the protection of the environment: we use environmentally friendly paper.

Contents

Warnings	3	Washing hints	10
Disposal	4	Sorting the laundry	10
Tips for environmental protection	4	Before loading the laundry	10
Technical specifications	4	Maximum loads	10
Installation	5	Laundry weights	10
Unpacking	5	Removing stains	10
Positioning	5	Detergents and additives	11
Water inlet	5	Quantity of detergents to be used	11
Water drainage	6	Internationnal wash code symbols	12
Electrical connection	6	Operating sequence	13-15
Your new washing machine	7	Washing programmes	16-17
Description of the appliance	7	Maintenance	18
Detergent dispenser drawer	7	Bodywork	18
Use	8	Door Seal	18
Control panel	8	Detergent dispenser drawer	18
Controls	8-9	Drain pump	18
		Water inlet filter	19
		Emergency emptying out	19
		Frost precautions	19
		Something not working?	20-21

Warnings

The following warnings are provided in the interests of overall safety. You must read them carefully before installing or using the appliance.

Installation

- All internal packing must be removed before using the appliance. Serious damage may be caused to the machine or adjacent furniture if the protective transit devices are not removed or are not completely removed. Refer to the relevant paragraph in the instruction book.
- Any electrical work required to install this appliance must be carried out by a qualified electrician.
- Any plumbing work required to install this appliance must be carried out by a qualified plumber.
- After having installed the machine, check that it is not standing on its electrical supply cable.
- If the appliance is placed on a carpeted floor, ensure that air can circulate freely between the feet and the floor.

Use

- This appliance is designed for domestic use. It must not be used for purposes other than those for which it was designed.
- Only wash fabrics which are designed to be machine washed. Follow the instructions on each garment label.
- Do not overload the appliance. Follow the instructions in the instruction book.
- Make sure that all pockets are empty. Objects such as coins, safety pins, pins and screws can cause extensive damage.
- Do not machine wash garments saturated with petroleum, methylated spirits, trichlorethylene, etc. If such fluids have been used to remove stains prior to washing, wait until they have completely evaporated from the fabric before placing garments in the appliance.
- Place small items such as socks, belts, etc. in a cloth bag or pillowcase to prevent them getting trapped between the drum and the tub.

- Use only the recommended quantities of fabric softener. An excessive amount could damage the laundry.
- Leave the porthole door slightly ajar when the appliance is not in use. This preserves the door seal and prevents the formation of musty smells.
- Always check that water has emptied out before opening the door. If not, drain the water following the instructions in the instruction book.
- Always unplug the appliance and shut the water tap after use.

General safety

- Repairs to the machine must be carried out only by qualified personnel. Repairs carried out by inexperienced persons could cause serious danger. Contact your local Service Centre.
- Never pull the power supply cable to remove the plug from the socket; always take hold of the plug itself.
- During high temperature wash programmes the door glass may get hot. Do not touch it!

Child safety

- Children are often not aware of how dangerous electrical appliances can be. When the machine is working, children should be carefully supervised and not be allowed to play with the appliance.
- The packaging components (e.g. plastic film, polystyrene) can be dangerous to children - danger of suffocation! Keep them out of children's reach.
- Keep all detergents in a safe place out of children's reach.
- When the appliance is to be scrapped, cut off the electrical supply cable and destroy the plug with the remaining cable. Disable the door catch in order to prevent children from becoming trapped inside while playing.

Disposal

Packaging materials

The materials marked with the symbol  are recyclable.

>PE<=polyethylene

>PS<=polystyrene

>PP<=polypropylene

This means that they can be recycled by disposing of them properly in appropriate collection containers.

Machine

Use authorised disposal sites for your old appliance.
Help to keep your country tidy!

Tips for environmental protection

To save water, energy and to help protect the environment, we recommend that you follow these tips:

- Normally soiled laundry may be washed without prewashing in order to save detergent, water and time (the environment is protected too!).
- The machine works more economically if it is fully loaded.
- With adequate pre-treatment, stains and limited soiling can be removed; the laundry can then be washed at a lower temperature.
- Measure out detergent according to the water hardness, the degree of soiling and the quantity of laundry being washed.

Technical specifications

DIMENSIONS

Height	85 cm
Width	60 cm
Depth	60 cm

MAXIMUM LOAD

Cotton	8 kg
Synthetics	3.5 kg
Delicates	3.5 kg
Woollens	2 kg
Handwash	2 kg
Silk	1 kg

SPIN SPEED max

800 rpm

POWER SUPPLY VOLTAGE/FREQUENCY

220-240V / 50HZ

TOTAL POWER ABSORBED

2200W

MINIMUM FUSE PROTECTION

10A

WATER PRESSURE

Minimum	50kPa
Maximum	800kPa



This appliance complies with the following EEC Directives:

73/23/EEC of 19/02/73 relating to low voltage

89/336/EEC of 03/05/89 relating to electromagnetic compatibility.

Installation

Unpacking

 All transit bolts and packing must be removed before using the appliance.

You are advised to keep all transit devices so that they can be refitted if the machine ever has to be transported again.

- Using a spanner, unscrew and remove the two rear bottom screws. Slide out the two plastic pins. Lay the machine on its back, taking care not to squash the hoses. This can be avoided by placing one of the corner packing pieces between the machine and the floor

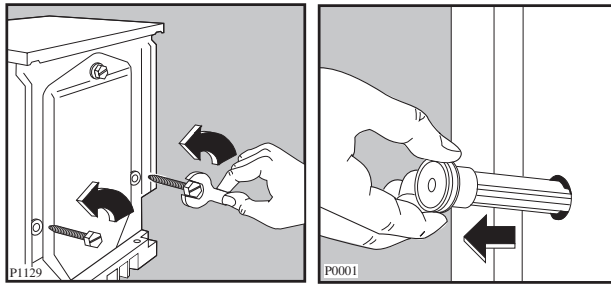

- Remove the polystyrene block(s) from the bottom of the machine and release the two plastic bags.
- Very carefully slide out the left polythene bag, removing it towards the right and then downwards.

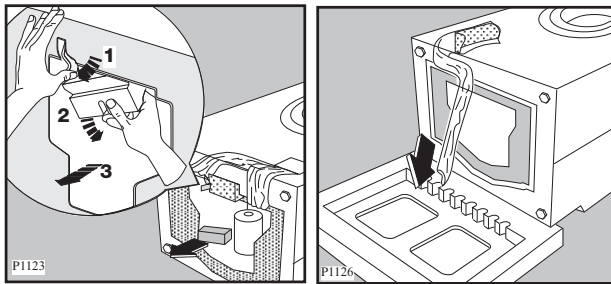

- Very carefully slide out the right polythene bag, removing it towards the left and then upwards. Remove the bottom cover placed into the drum of your appliance, lay its hook as the arrow 'A' indicates and push the top of the cover to seal it closed

Important: You can find more detailed instructions regarding the bottom cover assembling in its relative bag.

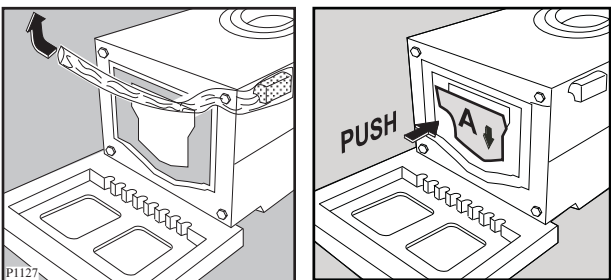

- Set the machine upright and remove the remaining rear screw. Slide out the relevant pin.
- Plug all the holes with the plugs which you will find in the envelope containing the instruction manual.

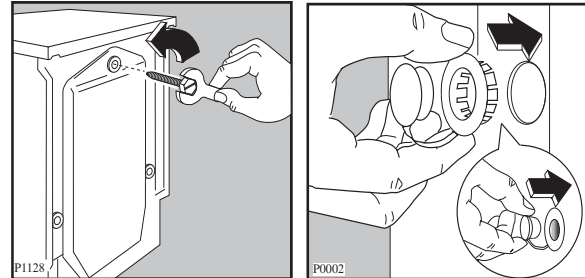

Positioning

Install the machine on a flat hard floor. Make sure that air circulation around the machine is not impeded by carpets, rugs etc. Check that the machine does not touch the wall or cupboard units. Carefully level by screwing the adjustable feet in or out. Never place cardboard, wood or similar materials under the machine to compensate for any unevenness in the floor.

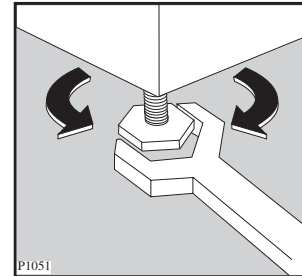

Water inlet

Connect the water inlet hose to a tap with 3/4" BSP thread.

Use the hose supplied with the washing machine. **DO NOT USE OLD HOSES.**

The other end of the inlet hose which connects to the machine can be turned in any direction. Simply loosen the fitting, rotate the hose and retighten the fitting, making sure there are no water leaks.

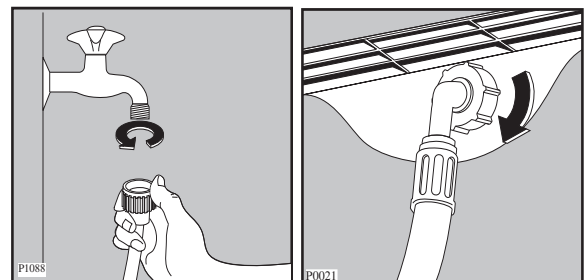

The inlet hose must not be lengthened. If it is too short and you do not wish to move the tap, you will have to purchase a new, longer hose specially designed for this type of use.

Water drainage

The end of the drain hose can be positioned in three ways:

Hooked over the edge of a sink using the plastic hose guide supplied with the machine. In this case, make sure the end cannot come unhooked when the machine is emptying.

This could be done by tying it to the tap with a piece of string or attaching it to the wall.

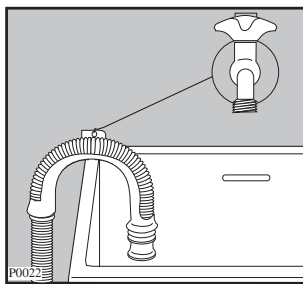

In a sink drain pipe branch. This branch must be above the trap so that the bend is at least 60 cm above the ground.

Directly into a drain pipe at a height of not less than 60 cm and not more than 90 cm.

The end of the drain hose must always be **ventilated**, i.e. the inside diameter of the drain pipe must be larger than the outside diameter of the drain hose.

The drain hose must not be kinked. Run it along the floor; only the part near the drainage point must be raised.

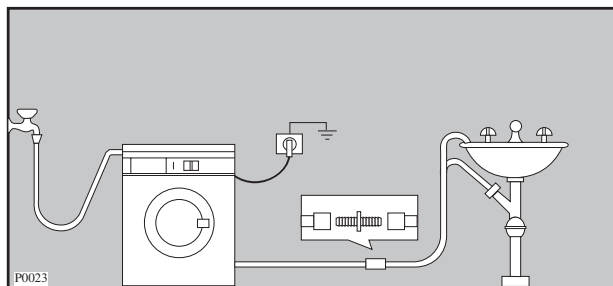

For the correct functioning of the machine the drain hose must remain hooked on the proper support piece situated on the top part of back side of the appliance

Electrical connection

This machine is designed to operate on a 230-240 V, single-phase, 50 Hz supply.

Check that your domestic electrical installation can take the maximum load required (2.05 kW), also taking into account any other appliances in use.

Connect the machine to an earthed socket.



The manufacturer declines any responsibility for damage or injury through failure to comply with the above safety precaution.

Should the appliance power supply cable need to be replaced, this must be carried out by our Service Centre.

The appliance is supplied with a 13amp plug fitted. In the event of having to change the fuse in the plug supplied, a 13amp ASTA approved (BS1363/A) fuse must be used.

Should the plug need to be replaced for any reason, proceed as described below.

The wires in the mains lead are coloured in accordance with the following code:

Green and Yellow	- Earth
Blue	- Neutral
Brown	- Live

The wire coloured green and yellow must be

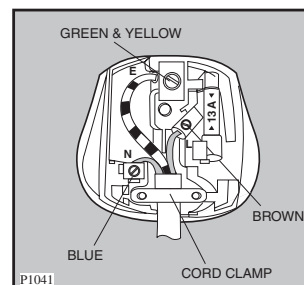

connected to the terminal marked with the letter «E» or by the earth symbol \perp or coloured green and yellow.

The wire coloured blue must be connected to the terminal marked «N» or coloured black.

The wire coloured brown must be connected to the terminal marked «L» or coloured red.

Upon completion there must be no cut, or stray strands of wire present and the cord clamp must be secure over the outer sheath.

Your new washing machine

This new machine, which is fitted with the New Jet System, meets all modern requirements for effective treatment of laundry with low water, energy and detergent consumption.

- **The special Handwash programme** with its new delicate wash system treats your delicate items with extreme care.
- **The special wool programme** with its new delicate wash system treats your woollens with extreme care.
- **The balance control device** ensures the machine is stable during the spin.



ENGLISH

Description of the appliance

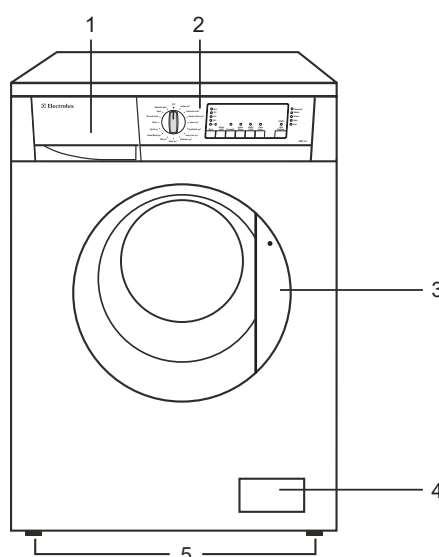
1. Detergent dispenser drawer
2. Control panel
3. Door handle
4. Drain pump
5. Adjustable feet



Detergent dispenser drawer

-  Pre-wash
-  Main wash
-  Fabric softener, starch

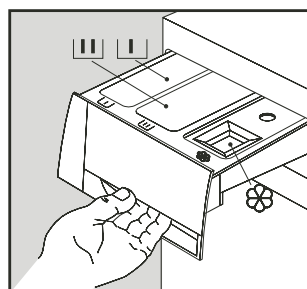

Use

Control panel

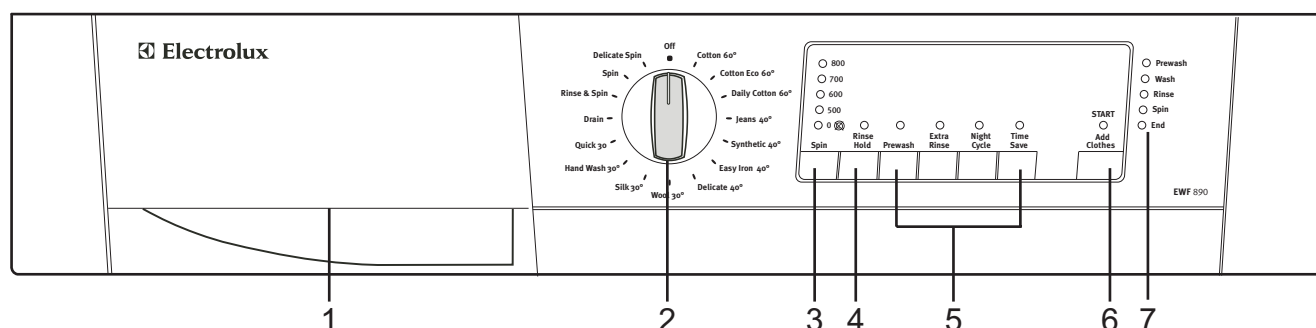

1. Detergent Dispenser Drawer

2. Programme selector dial

The programme selector dial is divided into three sections:

1. Cotton 60°, Cotton Eco 60°, Daily Cotton 60° (Green section)
2. Jeans 40°, Synthetics 40°, Easy iron 40°, Delicates 40°, Wool 30°, Silk Wool 30°, Hand Wash Wool 30°, Quick30 (Blue section)
3. Drain, Rinse & Spin, Spin, Delicate Spin (grey section)

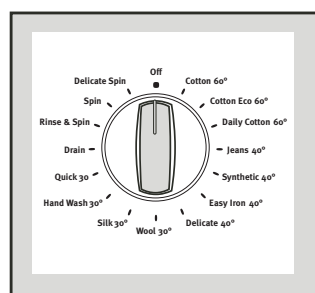

The selector dial can be turned either clockwise or anti-clockwise. Position “Daily Cotton Wool 60°” corresponds to an energy saving programme for cotton and to “Off ” to reset programme or switching OFF the machine. At the end of programme, the selector dial must be turned to position “Off ” to switch the machine OFF

3. Spin Speed button “Spin”

Press this button repeatedly to change the spin speed, if you want your laundry to be spin at a speed different from the one proposed by the washing machine and the relevant LED will light up.

By pressing the Spin speed button you can also choose **No Spin** option.

No Spin option : when you choose this option, the machine will drain the water of the last rinse, and eliminate the spin phase. To spin the Laundry, select spin or delicate spin programme.

Select the desired spin speed by pressing this button and press Start/ Add Clothes button.

4. Rinse Hold Button

when you choose this option, the machine will not drain the water of the last rinse, so as not to wrinkle the laundry.

At the end of cycle, the light of “Start/ Add Clothes” button goes off, the light corresponding to rinse hold option and “End” pilot light remain lit.

There are two possibilities to drain out the water.

- Select the programme “Drain”
The water is drained out without spinning
- Select programme “Spin” or “Delicate Spin”
Select the spin speed by means of the relevant button and press the “Start/ Add Clothes” button.
The water is emptied out and the laundry is spun at the selected speed.

Attention: Before selecting “Drain”, “Spin” or “Delicate spin” programme, the selector dial has to be positioned on “Off”.

5. Options Button

Depending on the programme, different functions can be combined. These must be selected after choosing the desired programme and before pressing the “Start / Add Clothes” button.

When these buttons are pressed, the corresponding LED will light up. When they are pressed again, the corresponding LED goes out.

Press these buttons to select the following options:

1.Prewash: Select this option if you wish your laundry to be prewashed before the main wash (not available for wool ,handwash ,mini programme and silk programmes.)

The Prewash ends with a short spin at 650 rpm in programmes for cotton and synthetic fabrics, whereas in the programme for delicate fabrics the water is only drained.

2.Extra Rinse: This option can be selected with all programmes, except the wool and handwash programme. The machine will add 2 rinses for cottons and 1 rinse for synthetics, delicates and silk programme.This option is recommended for people who are allergic to detergents, and in areas where the water is very soft.

3 Night Cycle: This option can be selected with all programmes. It eliminates all spin phases of the cycle, increasing the number of rinses, stops the cycle before final spin with water in the drum, eliminating the buzzer signal.To continue, it is necessary to select a drain or spin cycle.

4.Time Save: This option can be used for lightly soiled (not for wool, hand wash, silk and miniprogramme) in order to obtain a good washing programme in a short time. The washing time will be reduced according to the type of fabric .

6. Start/ Add Clothes Button



This button has 2 functions:

Start:

after you have selected the desired programme and options, press this button to start the washing machine. The light close to the button will stop flashing and remain lit.

Add Clothes:

When you press this button again, the programme in progress is interrupted. The light close to the button will start flashing. To restart the programme, press the button again. When you press "Add Clothes", it becomes possible to open the door if:

The washing machine is not in the heating phase;

The level of the water is not high;

The drum is not turning.

Important! You must pause the washing machine before you make any change in the programme in progress, by pressing "START/ Add Clothes" button.

7. Programme Phase indicator Light

By selecting the wash programme, the LED corresponding to the various phases making up the programme lights.

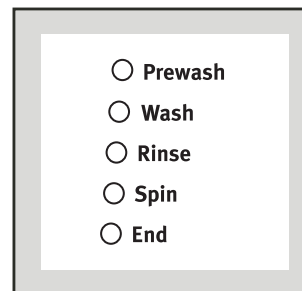

After you have started the programme, only the LED relevant to the phase that is currently being carried out will remain lit.

At the end of the programme the "End" LED illuminates.

i Washing hints

Sorting the laundry

Follow the wash code symbols on each garment label and the manufacturer's washing instructions. Sort the laundry as follows:
whites, coloureds, synthetics, delicates, woollens.

Before loading the laundry

Never wash whites and coloureds together. Whites may lose their "whiteness" in the wash.

New coloured items may run in the first wash; they should therefore be washed separately the first time.

Make sure that no metal objects are left in the laundry (e.g. hair clips, safety pins, pins).

Button up pillowcases, close zip fasteners, hooks and poppers. Tie any belts or long tapes.

Remove persistent stains before washing. Rub particularly soiled areas with a special detergent or detergent paste.

Treat curtains with special care. Remove hooks or tie them up in a bag or net.

Maximum loads

Recommended loads are indicated in the programme charts.

General rules:

Cotton, linen: drum full but not too tightly packed;

Synthetics: drum no more than half full;

Delicate fabrics and woollens: drum no more than one third full.

Washing a maximum load makes the most efficient use of water and energy.

For heavily soiled laundry, reduce the load size.

Laundry weights

The following weights are indicative:

bathrobe	1200 g
napkin	100 g
quilt cover	700 g
sheet	500 g
pillow case	200 g
tablecloth	250 g
towels	200 g
tea cloth	100 g
night dress	200 g
ladies' briefs	100 g
man's work shirt	600 g
man's shirt	200 g
man's pyjamas	500 g
blouse	100 g
men's underpants	100 g

Removing stains

Stubborn stains may not be removed by just water and detergent. It is therefore advisable to treat them prior to washing.

Blood: treat fresh stains with cold water. For dried stains, soak overnight in water with a special detergent then rub in the soap and water.

Oil based paint: moisten with benzine stain remover, lay the garment on a soft cloth and dab the stain; treat several times.

Dried grease stains: moisten with turpentine, lay the garment on a soft surface and dab the stain with the fingertips and a cotton cloth.

Rust: oxalic acid dissolved in hot water or a rust removing product used cold. Be careful with rust stains which are not recent since the cellulose structure will already have been damaged and the fabric tends to hole.

Mould stains: treat with bleach, rinse well (whites and fast coloureds only).

Grass: soap lightly and treat with bleach (whites and fast coloureds only).

Ball point pen and glue: moisten with acetone (*), lay the garment on a soft cloth and dab the stain.

Lipstick: moisten with acetone as above, then treat stains with methylated spirits. Remove any residual marks from white fabrics with bleach.

Red wine: soak in water and detergent, rinse and treat with acetic or citric acid, then rinse. Treat any residual marks with bleach.

Ink: depending on the type of ink, moisten the fabric first with acetone (*), then with acetic acid; treat any residual marks on white fabrics with bleach and then rinse thoroughly.

Tar stains: first treat with stain remover, methylated spirits or benzine, then rub with detergent paste.

(*) do not use acetone on artificial silk.

Detergents and additives

Good washing results also depend on the choice of detergent and use of the correct quantities to avoid waste and protect the environment. Although biodegradable, detergents contain substances which, in large quantities, can upset the delicate balance of nature.

The choice of detergent will depend on the type of fabric (delicates, woollens, cottons, etc.), the colour, washing temperature and degree of soiling.

All commonly available washing machine detergents may be used in this appliance:

- powder detergents for all types of fabric,
- powder detergents for delicate fabrics (60°C max) and woollens,
- liquid detergents, preferably for low temperature wash programmes (60°C max) for all types of fabric, or special for woollens only.

The detergent and any additives must be placed in the appropriate compartments of the dispenser drawer before starting the wash programme.

If using concentrated powder or liquid detergents, a programme **without** prewash must be selected.

The washing machine incorporates a recirculation system which allows an optimal use of the concentrated detergent.

Pour liquid detergent into the dispenser drawer compartment marked  **just before** starting the programme.

Any fabric softener or starching additives must be poured into the compartment marked  before starting the wash programme.

Follow the product manufacturer's recommendations on quantities to use and **do not exceed the «MAX» mark in the detergent dispenser drawer.**

Quantity of detergent to be used

The type and quantity of detergent will depend on the type of fabric, load size, degree of soiling and hardness of the water used.

Water hardness is classified in so-called “degrees” of hardness. Information on hardness of the water in your area can be obtained from the relevant water supply company, or from your local authority.













Follow the product manufacturers' instructions on quantities to use.



Use less detergent if:





- you are washing a small load,
- the laundry is lightly soiled,
- large amounts of foam form during washing.





International wash code symbols







These symbols appear on fabric labels, in order to help you choose the best way to treat your laundry.

Energetic wash   Delicate wash	 Max. wash temperature 95°C	 Max. wash temperature 60°C	 Max. wash temperature 40°C	 Max. wash temperature 30°C	 Hand wash	 Do not wash at all
		 				

 Bleaching	 Bleach in cold water	 Do not bleach
---	---	--

 Ironing	 Hot iron max 200°C	 Warm iron max 150°C	 Lukewarm iron max 110°C	 Do not iron
---	---	--	--	--

 Dry cleaning	 Dry cleaning in all solvents	 Dry cleaning in perchlorethylene, petrol, pure alcohol, R 111 & R 113	 Dry cleaning in petrol, pure alcohol and R 113	 Do not dry clean
--	---	--	---	---

 Drying	 Flat	 On the line	 On clothes hanger	 high temperature  low temperature Tumble dry	 Do not tumble dry
--	---	--	---	---	--

i Operating sequence

Before the first wash we recommend that you pour 2 litres of water into the main wash compartment **U** of the detergent drawer. Then run a cotton 60°C cycle, with the machine empty, in order to remove any manufacturing residue from the drum and tub.

Pour half a measure of detergent into the main wash compartment and start up the machine.

1. Place the laundry in the drum

Open the door. Place the laundry in the drum, one item at a time, shaking them out as much as possible. Close the door.

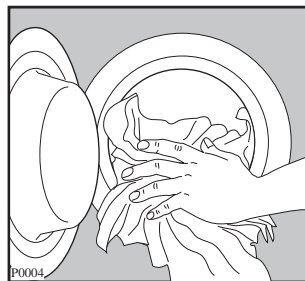

2. Measure out the detergent

Pull out the dispenser drawer until it stops. Measure out the amount of detergent recommended by the manufacturer in a graduated cup and pour it into the main wash compartment **U**.

If you wish to carry out the prewash or soak phase, pour detergent into the appropriate compartment marked **U**.

3. Measure out the additive

If required, pour fabric softener into the compartment marked **W**, **without exceeding the «MAX» mark.**

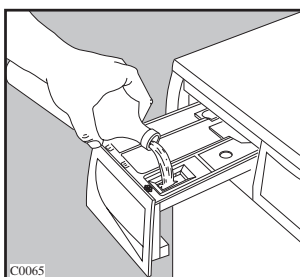
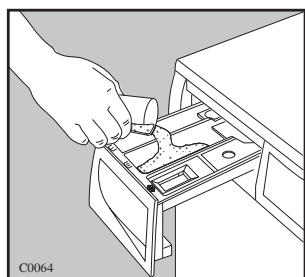

4. Switch the machine ON and OFF

Turn the selector dial to the desired programme to the switch appliance on. To switch the appliance off turn it to "Off".

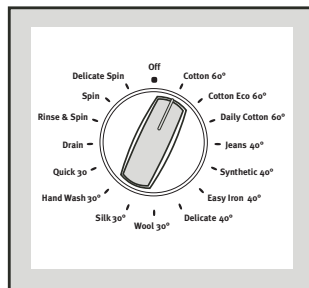

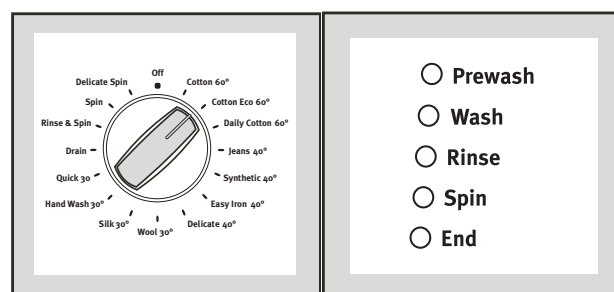

5. Select the desired programme

Turn the selector dial to the desired position: the LED corresponding to the different phases making up the selected programme illuminate.



6. Select the spin speed or No Spin Option

Press the “Spin” button repeatedly, in order to select the desired spin speed or the No Spin  option. The relevant LED will light up.

If you select the No Spin  option, the machine will stop at the end of the programme eliminating the spin phase.

EWF 890

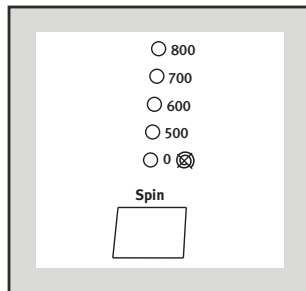

7. Select the desired option

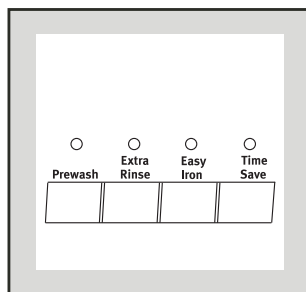

Press the relevant button to select the required options. Depending on the selected programme, only certain options are available and shown during the selection phase.

Note: Not all the options are compatible between themselves. The incompatible option icons will disappear.

8. Start the Programme

Press the “Start/Add clothes” button. The relevant LED will stop flashing, and only the LED relevant to the phase that is in progress will remain lit.

9. How to change a programme during its cycle

You can alter the programme before it starts. When the programme has started, you can only reset it by turning the programme selector dial to «Off» position and then you can select the new programme. Start it by pressing the “Start/Add clothes” button.

10. How to interrupt a programme during its cycle

Press the “Start/Add clothes” button to interrupt a programme which is running, the corresponding LED starts to flash. Press the same button again to restart the programme.

11. Cancelling a programme

Turn the selector dial to position «Off» to cancel a programme which is running. Now you can select a new programme.

12. How to open the door during the cycle of a programme

You can open the door, after having set the washing machine to PAUSE phase, by pressing “Start/Add clothes” button provided the following conditions exist:



- 1) the washing machine is not in the heating phase beyond 55°C
- 2) the level of the water is not high;
- 3) the drum is not turning.

After approximately 3 minutes, you can open the door.

Pay attention to the level of the water in the washing machine!

13. End of programme

The washing machine stops automatically at the end of the programme giving an audible signal.

If the No Spin  option has been selected, the LED of the “Start/Add clothes” button goes off, the LED  and the “End” LED remain lit to indicate that the spin phase is eliminated.

To spin the laundry select the spin speed by means of the relevant button and then press the “Start/Add clothes” button. The laundry is spun at the selected spin speed.

Turn the programme selector dial to position «Off» to switch the machine off.

Remove the laundry from the washing machine.

Check whether the drum is completely empty, by rotating it with your hand. The purpose of this is to prevent any items of laundry from remaining accidentally in the drum, where they might get damaged in a subsequent wash (e.g. by shrinking) or bleed colour into another load of laundry.

We advise you to close the water supply tap and disconnect the plug from the socket.

Leave the door ajar in order to air the washing machine.

Programme table

Washing Programmes

Wash programmes Fabrics	Type of Laundry	Description of Programme	Available options	Max. Load
Cotton 60°	White and coloured cotton e.g Sheets, tablecloths, household linen	Main wash at 60°C 3 rinses Long spin	Prewash Extra Rinse Night Cycle No Spin Time Save	8 kg
Cotton Eco 60°	Coloured cotton e.g. shirts, blouses, towels and undergarments	Main wash at 60°C 3 rinses Long spin	Prewash Extra Rinse Night Cycle No Spin	4.5 kg
Daily Cotton 60°*	Economy wash for whites or fast coloured cotton or linen fabrics, normally soiled shirts	Main wash at 60°C 3 rinses Long spin	Prewash Extra Rinse Night Cycle No Spin	4.5 kg
Jeans 40°	Coloured cotton or linen fabric, normally soiled shirts, blouses	Main wash at 40°C 3 rinses Long spin	Prewash Time Save Extra Rinse No Spin Night Cycle	8 kg
Synthetics 40°	Synthetics or mixed fabric e.g lingerie, coloured garments	Main wash at 40°C 3 rinses Short spin	Prewash Time Save Extra Rinse No Spin	3.5 kg
Easy Iron 40°	Synthetics and Delicates	Main wash at 40°C 3 rinses Short spin	Prewash Time Save Extra Rinse No Spin Night Cycle	3.5 kg
Delicate 40°	Delicate fabrics, e.g. acrylics, Polyester mixture	Main wash at 40°C 3 rinses Short spin	Prewash Time Save Extra Rinse No Spin Night Cycle	3.5 kg
Wool 30°	Delicate fabrics, Silk to be handwashed	Main wash at 30°C 3 rinses Short spin	Night Cycle No Spin.	2 kg
Silk 30°	Clothes labelled "Pure new wool, non-shrink machine washable" and silk fabric	Main wash at 30°C 3 rinses Short spin	No Spin Night Cycle Extra Rinse	1 kg

*This programme at 60c is the reference program for the energy label according to EEC directive 92/75

Programme table

Special Programmes

Wash programmes Fabrics	Type of Laundry	Description of Programme	Available options	Max. Load
Hand Wash 30°	Special programme for hand washing fabrics.	Main Wash at 30°C 3 Rinses Short Spin	No Spin Night Cycle	2 kg
Quick 30	Special Programme for extremely delicate items	Main Wash at 30°C 3 Rinses Short Spin	No Spin Night Cycle	4.5 kg
Drain	For Draining out last rinse water in programmes with the rinse hold option	Draning Of Water		8 kg
Rinse & Spin	Separate rinse cycle for hand washed items of cotton fabrics.	3 rinses with liquid additive if required long spin at maximum speed.	No Spin Night Cycle Extra Rinse	8 kg
Spin	Seperate Spin for Cottons	Drain and Spin at maximum speed		8 kg
Delicate Spin	Seperate spin for delicate items	Short Spin		3.5 kg

Maintenance

1. Bodywork

Clean the outside of the machine with soap and water only. Rinse with clean water and dry with a soft cloth.

Important: do not use methylated spirits, solvents or similar products to clean the bodywork.

2. Door seal

Check from time to time the door seal and eliminate eventual possible objects that could be trapped in the fold.

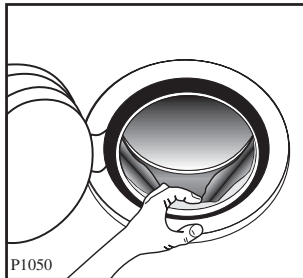

3. Detergent dispenser drawer

After a while, detergents and fabric softeners leave deposits in the drawer.

Clean the drawer from time to time by rinsing it under a running tap. To remove the drawer from the machine, press the button in the rear left-hand corner.

To facilitate cleaning, the top part of the additive compartments can be removed.

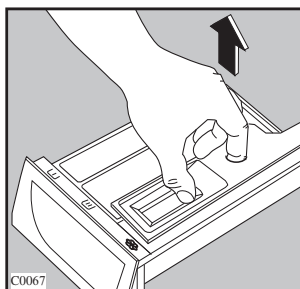
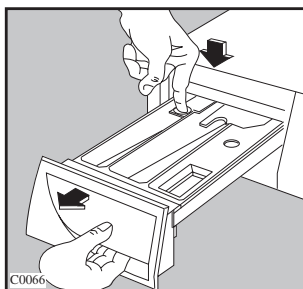

Detergent can also accumulate inside the drawer recess: clean it with an old toothbrush. Refit the drawer after cleaning.

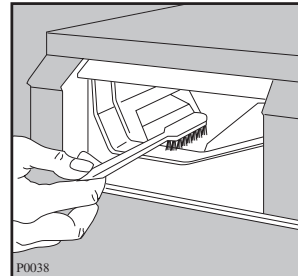

4. Drain pump

The pump should be inspected if

- the machine does not empty and/or spin
- the machine makes an unusual noise during draining due to objects such as safety pins, coins etc. blocking the pump.

Proceed as follows:

- Disconnect the appliance.
- If necessary wait until the water has cooled down.
- Open the pump door.

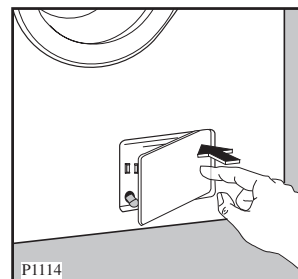

- Place a container close to the pump to collect any spillage.
- Release the emergency emptying hose, place it in the container and remove its cap.
- When no more water comes out, unscrew the pump cover and remove the pump. Always keep a rag nearby to dry up spillage of water when removing the pump.

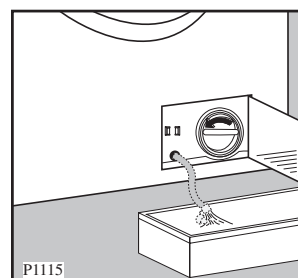

- Remove any objects from the pump impeller by rotating it.

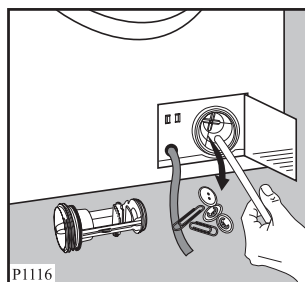

- Put the cap back on the emergency emptying hose and place the latter back in its seat.



- Screw the pump cover fully in.
- Close the pump door.

5. Water inlet filter

If you notice that the machine is taking longer to fill, check that the filter in the water inlet hose is not blocked.

Turn off the water tap.

Unscrew the hose from the tap.

Clean the filter with a stiff brush.

Screw the hose back onto the tap.

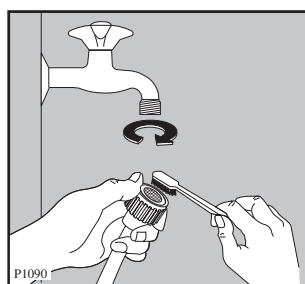

6. Emergency emptying out

If the water is not discharged, proceed as follows to empty out the machine:

- pull out the plug from the power socket;
- close the water tap;
- if necessary, wait until the water has cooled down;
- open the pump door;
- place a bowl on the floor and place the end of the emergency emptying hose into the bowl. Remove its cap. The water should drain by gravity into the bowl. When the bowl is full, put the cap back on the hose. Empty the bowl. Repeat the procedure until water stops flowing out;
- clean the pump if necessary as previously described;
- replace the emergency emptying hose in its seat after having plugged it;
- screw the pump cover again and close the door.

7. Frost precautions

If the machine is installed in a place where the temperature could drop below 0°C, proceed as follows:

- Remove the plug from the socket.
- Close the water tap and unscrew the water inlet hose from the tap.
- Place the end of the emergency emptying hose and that of the inlet hose in a bowl placed on the floor and let water drain out.
- Screw the water inlet hose back on and reposition the emergency emptying hose after having put the cap on again.

By doing this, any water remaining in the machine is removed, avoiding the formation of ice and, consequently, breakage of the affected parts.

When you use the machine again, make sure that the ambient temperature is above 0°C.

Something not working?

Certain problems are due to lack of simple maintenance or oversights, which can be solved easily without calling out an engineer. Before contacting your local Service Force Centre, please carry out the checks listed below.

IMPORTANT: if you call out an engineer to a fault listed below, or to repair a fault caused by incorrect use or installation, a charge will be made even if the appliance is under guarantee.

Once the problem has been eliminated, press the START/ADD CLOTHES button to restart the programme. If after all checks, the problem persists, contact your local Service Force Centre.

Problem	Possible causes
The machine does not start	<ul style="list-style-type: none"> • The door has not been closed. • The plug is not properly inserted in the power socket. • There is no supply at the socket. • The main fuse has blown. • The Start/Add Clothes button has not been pressed.
The machine does not fill	<ul style="list-style-type: none"> • The water tap is closed. • The filter in the inlet hose is blocked. • The inlet hose may be squashed or kinked. • The door has not been closed.
The machine fills then empties immediately	<ul style="list-style-type: none"> • The end of the drain hose is too low. • The end of the drain hose is submerged in water. • There is no vent in the end of the drain hose.
The machine does not empty and/or does not spin	<ul style="list-style-type: none"> • The drain hose may be squashed or kinked. • The option  has been selected. • The drain pump may be blocked. • The drain hose extension, if fitted, is not correct. Follow the instructions for connecting to the waste. • The drainage system pipes are blocked. • The wash load is unbalanced: redistribute the clothes inside the drum to allow the machine to spin.
There is water on the floor	<ul style="list-style-type: none"> • Too much detergent or unsuitable detergent has been used (creates too much foam). • Check whether there are any leaks from the inlet hose fittings. It is not always easy to see this as the water runs down the hose; check to see if it is damp. • The drain hose may be damaged or not securely positioned. • The detergent dispenser drawer or recess is clogged. • The drainage system pipes are blocked. • The cap on the emergency emptying hose has not been replaced after cleaning the pump.

Problem	Possible cause
<ul style="list-style-type: none"> • Unsatisfactory washing results: 	<ul style="list-style-type: none"> • Too little detergent or unsuitable detergent has been used. • Stubborn stains have not been treated prior to washing. • Excessive laundry load.
<ul style="list-style-type: none"> • The machine vibrates or is noisy: 	<ul style="list-style-type: none"> • The transit bolts and packing have not been removed. • The support feet have not been adjusted. • The laundry is not evenly distributed in the drum. • Maybe there is very little laundry in the drum.
<ul style="list-style-type: none"> • The door will not open: 	<ul style="list-style-type: none"> • The programme is still running. • The door lock has not been released. • There is water in the drum. <p>The door could be opened only when «Door openable» message appears in the display and the door locked light goes off.</p>
<ul style="list-style-type: none"> • Spinning starts late or the machine does not spin: 	<ul style="list-style-type: none"> • The electronic unbalance detection device has cut in because the laundry is not evenly distributed in the drum. The laundry is redistributed by reverse rotation of the drum. This may happen several times before the unbalance disappears and normal spinning can resume. If, after 10 minutes, the laundry is still not evenly distributed in the drum, the machine will not spin. In this case, redistribute the load manually and select the spin programme.

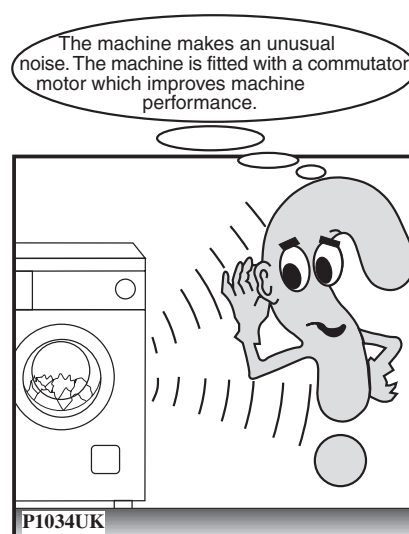
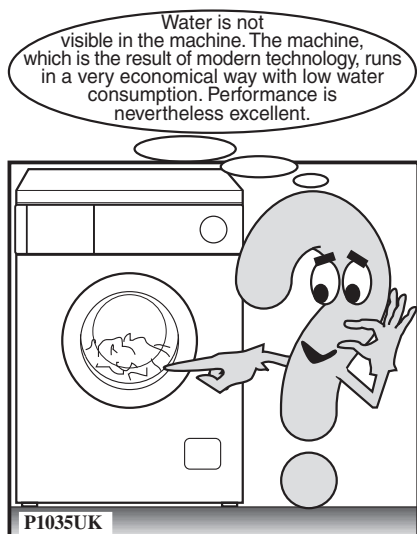

If you are unable to identify or solve the problem, contact our service centre. Before telephoning, make a note of the model, serial number and purchase date of your machine: the Service Centre will require this information.

