

**IGNIS**

---

# Service-Manual

## Freestanding Cooling - Combi ARL 428/G

---

<b>Model Version</b>		<b>Page</b>
ARL 428/G 8539 428 01000		
	Technical data	2
	Spare part list	3
	Exploded view	4
	Circuit diagram	6

## Technical data

### Dimensions

Height	185,0	cm
Width	59,2	cm
Depth	62,4	cm

### Capacity

#### Total

gross	352	l
net	330	l

### Cooling

gross	-	l
net	230	l

### Freezing

gross	-	l
net	100	l

### Electrical connection

Voltage	220 - 240	V
Frequency	50	Hz

### Power consumption

in 24 hours	1,48	kWh
-------------	------	-----

### Compressor (cooling)

Type	H6 AF 65	
Capacity (CECOMAF)	51	W

### Compressor (freezing)

Type	H 12 AF 67	
Capacity (CECOMAF)	100	W

### Cooling agent

Type	R 134 a	
Quantity	50 / 100	g

### Thermostat (cooling)

#### Switching value

Switch on temperature min.	+ 4,5	°C
Switch on temperature max.	+ 4,5	°C
Switch off temperature min.	- 16,0	°C
Switch off temperature max.	- 30,0	°C

### Thermostat (freezing)

#### Switching value

Switch on temperature min.	- 17,0	°C
Switch on temperature max.	- 25,0	°C
Switch off temperature min.	- 22,0	°C
Switch off temperature max.	- 30,0	°C

## Spare part list

**Model** ARL 428/G  
**Service No.** 853942801000  
**Version** 853942801000

Pos. No.	12NC Code	Description
011 0	<b>4819 505 18335</b>	Foot
041 0	<b>4819 417 19412</b>	Hinge,upper
041 2	<b>4819 417 19411</b>	Hinge,lower
041 3	<b>4819 417 19409</b>	Hinge,middle
041 7	<b>4819 462 58152</b>	Cover,hinge
045 9	<b>4819 535 98548</b>	Pin,hinge
071 0	<b>4819 442 68227</b>	Plinth
071 1	<b>4819 460 78196</b>	Insert,plinth
071 2	<b>4819 404 78921</b>	Support
101 0	<b>4819 442 38236</b>	Outdoor freez
104 0	<b>4819 442 68235</b>	Door refr.outer
105 4	<b>4819 466 89226</b>	Stop,door
105 5	<b>4819 466 89225</b>	Stop,door
111 0	<b>4819 498 78034</b>	Handle,door
111 1	<b>4819 462 79466</b>	Cover
111 4	<b>4819 459 19363</b>	Plate
152 0	<b>4819 418 79145</b>	Holder,bottles
154 0	<b>4819 418 79228</b>	Holder,bottles
155 0	<b>4819 460 88503</b>	Holder, eggs
156 0	<b>4819 418 78418</b>	Tray
171 0	<b>4819 460 89352</b>	Trim, grid
171 3	<b>4819 460 89355</b>	Trim,crisper
190 0	<b>4819 532 68737</b>	Gasket
191 0	<b>4819 468 18049</b>	Magnetic seal
191 1	<b>4819 468 18051</b>	Magnetic seal
233 0	<b>4819 466 98951</b>	Support f. Evaporator
241 6	<b>4819 458 58557</b>	Grid
242 0	<b>4819 418 79143</b>	Crisper
242 7	<b>4819 418 79138</b>	Basket
242 9	<b>4819 418 79142</b>	Basket
245 0	<b>4819 458 58556</b>	Grid
251 0	<b>4819 460 78198</b>	Guard
251 1	<b>4819 462 79771</b>	Cover,lamp
254 0	<b>4819 466 98953</b>	Switch lever
255 0	<b>4819 466 78357</b>	Crisper cover
257 7	<b>4819 466 98949</b>	Arret
257 8	<b>4819 466 98948</b>	Arret
301 0	<b>4819 452 99344</b>	Control panel
301 2	<b>4819 404 78926</b>	Support
301 4	<b>4819 460 78205</b>	Insert
324 0	<b>4819 460 78206</b>	Insert
332 0	<b>4819 410 28732</b>	Button
335 0	<b>4819 412 58462</b>	Knob thermostat
402 0	<b>4819 360 38522</b>	Compressor H6 AF65
402 1	<b>4819 418 78444</b>	Tray,compressor
403 0	<b>4819 360 38524</b>	Compressor H12 AF67
493 0	<b>4819 462 79046</b>	Lid f. connection block
493 1	<b>4819 462 79056</b>	Cover
526 0	<b>4819 214 78477</b>	Control unit
554 0	<b>4819 271 28906</b>	Thermostat
554 1	<b>4819 492 68723</b>	Spring
556 0	<b>4819 271 28907</b>	Thermostat
561 0	<b>4819 282 28571</b>	Protect,motor AD23BJ4
561 1	<b>4819 282 28499</b>	Protect,motor
561 2	<b>4819 290 68198</b>	Case

Pos. No.	12NC Code	Description
614 0	<b>4819 280 68313</b>	Relay PTC-Starting device
651 0	<b>4819 134 88178</b>	Lamp
740 0	<b>4819 511 48433</b>	Condenser
745 0	<b>4819 511 38641</b>	Evaporator
764 0	<b>4812 480 28007</b>	Dryer 15 g
764 1	<b>4819 480 28132</b>	Dryer 15 gr.
781 0	<b>4819 532 28145</b>	Defroster plug
781 1	<b>4819 418 78208</b>	Defrostingpipe
781 2	<b>4819 526 48307</b>	Coupling,pipe
903 0	<b>4819 462 79769</b>	Cover
904 2	<b>4819 462 78448</b>	Cap
912 0	<b>4819 502 18152</b>	Screw
912 1	<b>4819 502 18338</b>	Screw
934 2	<b>4819 492 68431</b>	Spring
993 2	<b>4819 690 28153</b>	Tool

**Exploded view**

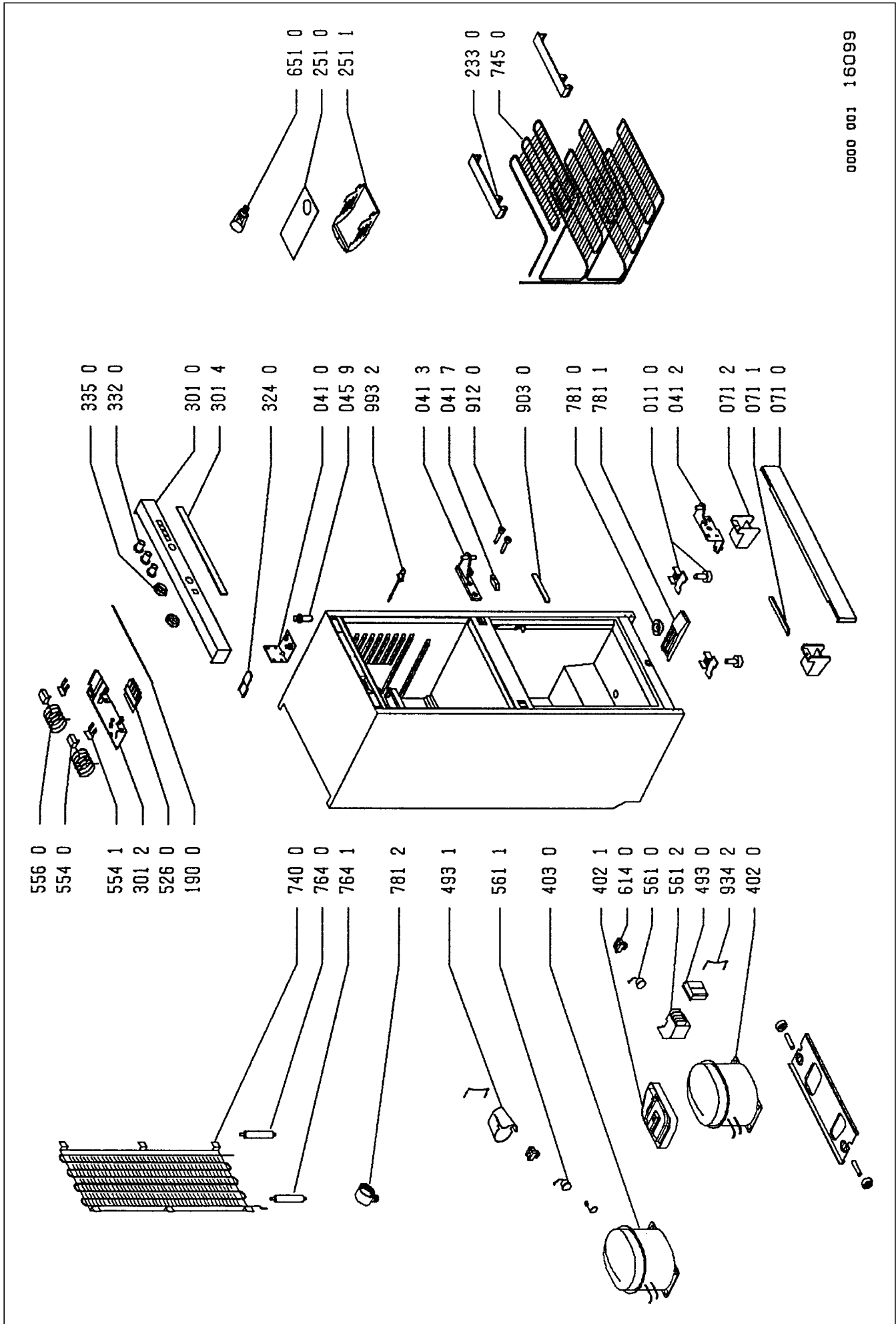

**Exploded view**

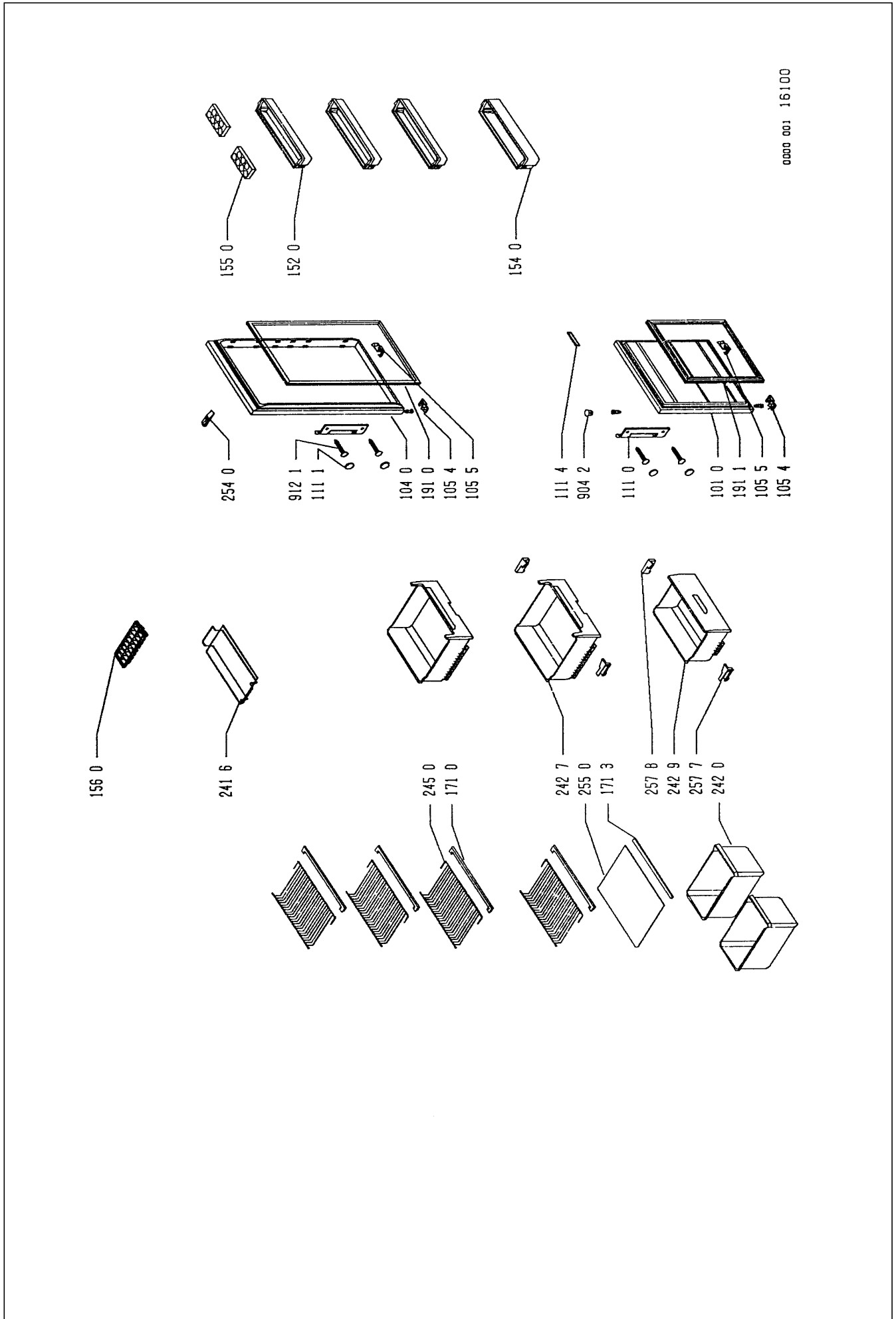

**Circuit diagram**

