

Philips Domestic Appliances and Personal Care

# Service Manual

## HINTS FOR REPAIRS

- Remove the shaving unit, to prevent damages during repairs.
- Remove screws A1 (2x, of which 1 is under trimmer slide).
- Take cover with trimmer from housing.
- Remove bracket (14 + 21).
- The PC-board can now be removed from the housing.
- Remove screws B1 (2x) the motor and hairchamber can now be removed from the housing.
- Detach the motor clamping springs (item 17) on the bearing block with a small screwdriver.

## GENERAL

- Mainsshaver possible.
- Converts input voltage 8-16V dc to constant Charge current (NiMH 1100mA, NiCd 680mA) or Constant motorvoltage at mainsshave. Start-up voltage min. 11V.
- Open battery protection.
- Undervoltage protection.
- Charging time is determined by Temperature (absolute or delta).
- Green mains LED (input voltage present).
- Electronic on/off.

## TECHNICAL DATA

Voltage	: 100-240 V 50/60Hz
Power consumption	: Motor depending
Motor voltage	: 2.4 V $\overline{\text{---}}$
Power supply	: SMPS
Speed of cutters	: > 2100 r.p.m.
Shaving heads	: HQ6 - 4822 690 10214
Battery	: Green NiCd pack AA

SAP CODING : 8856 825 99999

**This product meets the requirements regarding interference suppression on radio and TV.**

**After the product has been repaired, it should function properly and has to meet the safety requirements as officially laid down at this moment.**

## HQ6825/A

If the HQ6825/A shaver is supplied with a HQ8000 powerplug, remove R35 from the PCB.

Removing R35 will not adversely affect the shaver's performance.

If the shaver has been supplied with a HQ8000 plug, R35 and its surrounding will look burned. See picture.

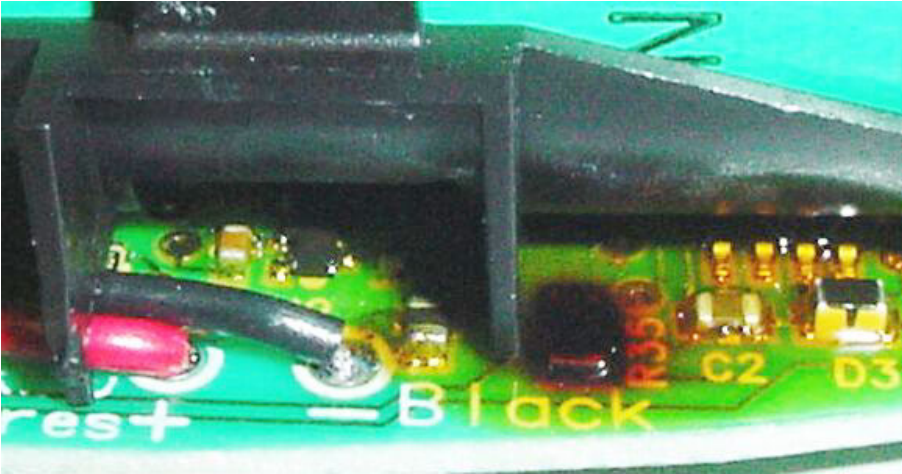

If the customer complaint can be related to battery capacity, also replace the battery.

# HQ6825/A

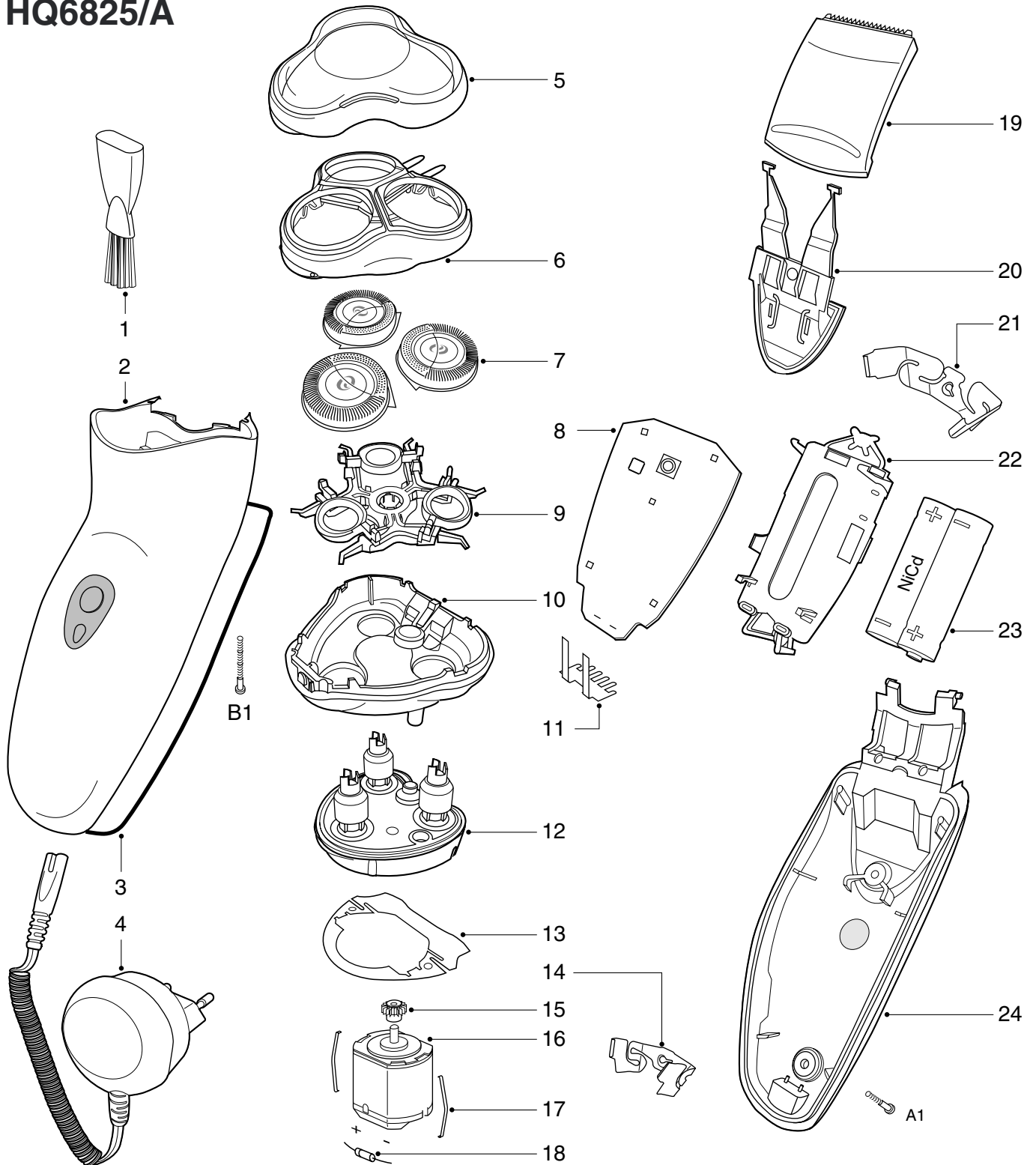

- 1 4822 479 20261 cleaning brush
- 2 4822 441 12328 housing PH
- 3 4822 466 12232 rubber seal
- 4 4822 219 10711 power plug EU
- 4822 219 10712 power plug ARG
- 4822 219 10713 power plug E-EU
- 4822 219 10714 power plug KOR
- 4822 219 10715 power plug GB
- 4822 219 10716 power plug CDN/TWN
- 4822 219 10717 power plug J
- 4822 219 10718 power plug AUS/NZ
- 4822 219 10719 power plug MEX
- 4822 219 10721 power plug PRC
- 5 4822 462 11177 protecting cap
- 6 4822 441 12327 head housing

- 7 4822 690 10214 HQ6 shaving head
- 8 4822 214 13049 power module
- 9 4822 402 11319 retaining bracket
- 10 4822 442 01819 hairchamber PH
- 11 4822 265 11548 connecting pins
- 12 4822 522 10762 gearwheel unit
- 13 4822 466 12233 sealing plate
- 14 4822 402 11318 bracket small
- 15 4822 522 10763 pinion
- 16 4822 361 21783 motor
- 17 4822 492 71735 motor clamp
- 18 4822 130 34167 Zener diode
- 19 4822 690 10213 trimmer
- 20 4822 463 11257 trimmer slide
- 21 4822 402 11317 bracket large

- 22 4822 532 13149 spacer AA
- 23 4822 138 10727 NiCd pack AA
- 24 4822 442 01818 cover
- A 4822 502 14657 s.t.screw spec/T8
- B 4822 502 14544 s.t.screw 1.8x18/T8
- 4822 600 10856 pouch PH
- 4822 736 16883 DFU (1)
- 4822 736 16884 DFU (2)
- (1) GB Arab Farsi E P/BR F
- (2) GB CN RC ROK T MAL RI VN
- \* 4222 036 01970 Car cord

