

# HQ 6852/A

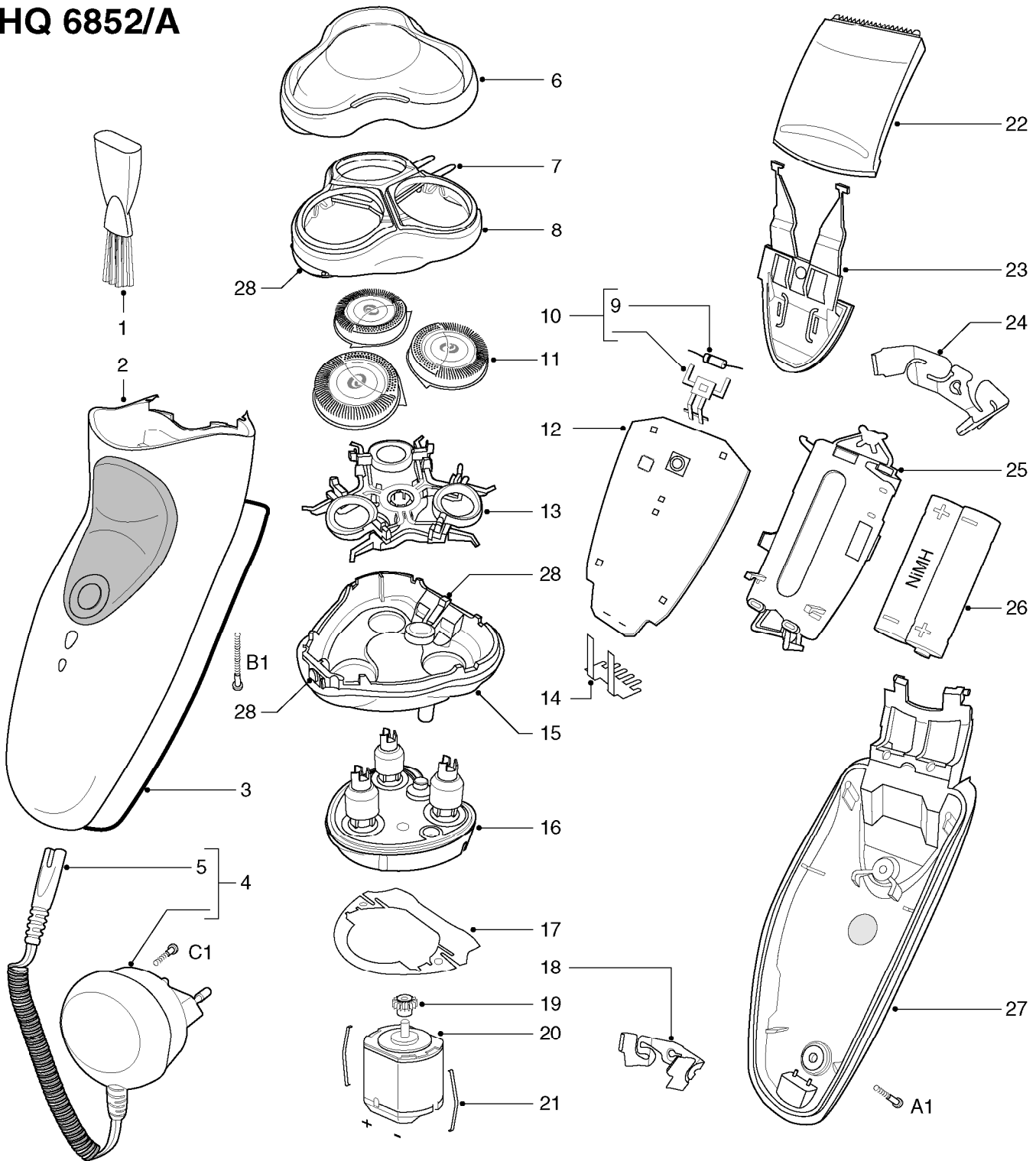

- |    |                |                   |    |                |                 |   |                |                     |
|----|----------------|-------------------|----|----------------|-----------------|---|----------------|---------------------|
| 1  | 4822 479 20261 | cleaning brush    | 14 | 4822 265 11548 | connecting pins | A | 4822 502 14657 | s.t.screw spec/T8   |
| 2  | 4222 036 04660 | housing           | 15 | 4822 442 01829 | hair chamber    | B | 4822 502 14544 | s.t.screw 1.8x18/T8 |
| 3  | 4822 466 12232 | rubber seal       | 16 | 4822 522 10762 | gearwheel unit  | C | 4822 502 30526 | s.t.screw 1.8x10/T8 |
| 4  | 4822 219 10711 | power plug EU     | 17 | 4822 466 12233 | sealing plate   |   | 4822 600 10858 | pouch PH            |
|    | 4822 219 10715 | power plug GB     | 18 | 4822 402 11318 | bracket small   |   | 4222 036 01240 | HQ6010 car cord     |
|    | 4822 219 10717 | power plug J      | 19 | 4822 522 10763 | pinion          |   |                |                     |
| 5  | 4222 036 03160 | curled flex       | 20 | 4822 361 21783 | motor 2.4V      |   |                |                     |
| 6  | 4822 462 11177 | protecting cap    | 21 | 4822 492 71735 | motor clamp     |   |                |                     |
| 7  | 4222 036 02950 | hinge spring      | 22 | 4822 690 10216 | trimmer         |   |                |                     |
| 8  | 4822 441 12327 | head housing      | 23 | 4822 463 11258 | trimmer slide   |   |                |                     |
| 9  | 4822 130 34167 | BZX79-C6V2 Zener  | 24 | 4822 402 11317 | bracket large   |   |                |                     |
| 10 | 4222 036 03200 | motor connector   | 25 | 4222 036 03020 | spacer AA/B     |   |                |                     |
| 11 | 4822 690 10214 | HQ6 shaving head  | 26 | 4822 138 10728 | NiMH pack AA    |   |                |                     |
| 12 | 4822 214 13056 | power module      | 27 | 4222 036 04620 | cover           |   |                |                     |
| 13 | 4822 402 11319 | retaining bracket | 28 | 4222 036 02960 | lock parts      |   |                |                     |