

4. EXPLODED VIEWS AND PARTS LIST

- NOTES**
- 1. Part numbers in boldface type are not supplied.
 - 2. The Δ mark found on some component parts indicates the importance of the safety factor of the part. Therefore, when replacing, be sure to use parts of identical designation.
 - 3. For your parts Stock Control, the fast moving items are indicated with the marks ** and *.
 - 4. ** GENERALLY MOVES FASTER THAN *
 - 5. * Distributor because it depends on model number, transportation, handling, etc.
 - 6. Parts marked with "Q" are not always kept in stock. Their delivery time may be longer than usual or they may be unavailable.

4.1 EXTERIOR Exploded View (Exterior Components)

Mark	No.	Part No.	Description	Mark	No.	Part No.	Description
Δ	1	GM-22	Strain relief	Δ	41	RMA1031	Bonnet
Δ	2	RDG-048	AC power cord	Δ	42	RBK1015	Spring
Δ	3	RNH-184	Cord clamp	Δ	43	BBZ20P030FMC	Screw
Δ	4	RNH-184	Cord clamp	Δ	44	BBZ20P030FMC	Screw
Δ	5	RIT1005	Power transformer (T1)	Δ	45	BBZ20P030FMC	Screw
	6	RBH1077	Door spring	Δ	46	BBZ30P060FZK	Screw
**	7	RBK1004	Half pressure spring		101		Mechanism unit
	8	REB-514	Counter belt		102		Motor shaft
	9	RAC1068	Door assembly		103		Motor shaft
	10	RNE1195	Operation bracket (L)		104		Name Plate
	11	RNE1205	Operation bracket (R)		105		Mechanism bracket
	12	RAC1068	Knob (POWER)		106		VFI knob guide
	13	RAC1068	Knob (STOP)		107		Front panel
	14	RAC1264	Button (PLAY)		108		Rear panel
	15	RAC1265	Button (REW)		109		Display unit
	16	RAC1269	Button (F.W)		110		Transistor unit
	17	RAC1286	Button (PAUSE)		111		Power transformer unit
	18	RAC1288	Knob (TAPE)		112		Transformer 1 unit
	19	RAC1075	Knob (MODE/DOLBY)		113		Transformer 2 unit
	20	RAC1075	Knob (SPEED)		114		Mechanism unit
	21	RAC1076	Knob (REC LEVEL)		115		Mechanism unit
	22	RAC1080	Knob (REC LEVEL)				
	23	RAM1003	Counter (S)				
	24	RAM1003	Counter (S)				
	25	REB1004	Stopper				
	26	REC-369	Leg assembly				
	27	REE-113	Remain display paper				
	28	RNK1058	Door pocket				
	29	RNH1267	Door panel (L)				
	30	RAH1267	Door panel (R)				
	31	RAH1268	Door panel (R)				
	32	RAH1290	Front panel				
	33	RXX1054	Function panel				
	34	RXX1054	Function panel				
	35	BBZ20P040FMC	Front panel assembly				
	36	PMA30P060FMC	Screw 3×6				
	37	ABZ30P030FMC	Screw 3×8				
	38	RFI1025				
	39	RFI1025				
	40	BBZ30P060FMC	Screw 3×8				

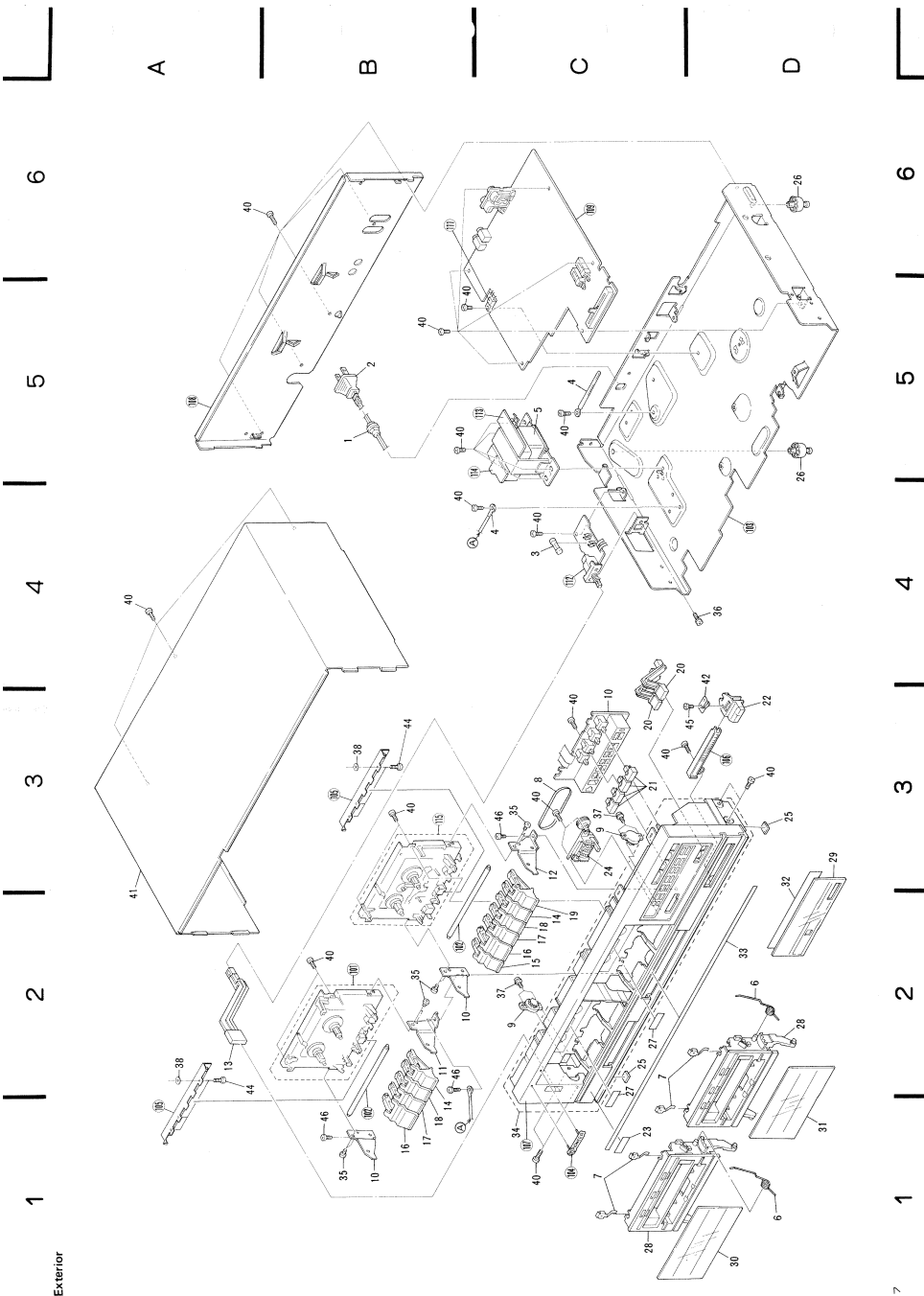

Exterior

Mechanism unit I, II

4.2 MECHANISM UNIT
Part List of KUC Type (Mechanism Unit I, II)

Mark	No.	Part No.	Description	Mark	No.	Part No.	Description
**	1	CDSD10J50	Ceramic Capacitor	45	RBFI001	Polyslider Washer	
**	2	RPB1006	RP Head	47	RBFI002	Polyslider Washer	
**	3	RSNI013	Leaf Switch	48	WAZ100400025	Polyslider Washer	
**	4	RSNI015	Leaf Switch (Mechanism Unit II)	49	WAZ100400025	Polyslider Washer	
**	5	RSNI014	Leaf Switch	50	RBE1004	Tooled Lock Washer	
**	6	RSNI021	Motor assembly (I)	51	REA1011	Tap The Screw	
**	7	RAA1201	Lever Base	52	REA1012	Tap The Screw (Mechanism unit I)	
**	8	RBH1064	Housing assembly	53	REA1060	Blind Tap The Screw	
**	9	RBH1064	P Flouter Spring	54	RBE1007	Head Spacer	
**	10	RAA1200	P Roller assembly	55	
**	11	RAA1202	Flywheel (B) assembly	56	
**	12	RAA1203	FR Arm Spring (A)	57	
**	13	RBH1173	FR Arm Spring (P)	58	
**	14	RBH1173	Back Tension Spring (B)	59	
**	15	RBH1176	Idle Spring (A)	60	RNK1360	REC Sensor (Mechanism unit II)	
**	16	RNK1355	S Reel	61	RNK1354	Pause Cam (A) (Mechanism unit II)	
**	17	RNK1356	FF Gear	62	RBH1167	Back Tension Spring (B) (Mechanism unit II)	
**	18	RNK1356	FF Gear (P)	63	RBH1175	REC Sensor (Mechanism unit II)	
**	19	RNK1372	Arm Bush	64	RPB1002	E Head (Mechanism unit I)	
**	20	RNK1372	Arm Bush (Mechanism unit I)	65	PZZZOP060FMC	Tapping Screw	
**	21	RAA1211	Idle assembly	100	Stop Lever (F)	
**	22	RAA1212	FR Pulley assembly (P)	101	3P Head Wire assembly (Mechanism unit II)	
**	23	RAA1213	T Reel assembly (P)	102	Wire assembly (Mechanism unit II)	
**	24	RAA1213	Head Base	103	SW Guard (Mechanism unit I)	
**	25	RNK1359	Head Base (Mechanism unit I)	104	Motor Bracket (F)	
**	26	RBH1165	Head Base (B) (Mechanism unit II)	105	Chassis assembly (P)	
**	27	RBH1166	Lever Spring	106	Head Chassis	
**	28	RBH1166	Lever Spring (B)	107	
**	29	RBH1169	Lock Cam	108	
**	30	RBH1172	Lock Cam Spring	109	
**	31	RBH1174	Auto Arm Spring	110	Play Lever (F)	
**	32	RNK1354	Lever Spring (C)	111	FF Lever (F)	
**	33	RNK1352	Auto Arm	112	FF Lever (P)	
**	34	113	Lock Cam	
**	35	RBH1168	Eject Lever Spring	114	Sensor Lever	
**	36	RNK1326	Eject Lever (P)	115	Pack Spring (P) (Mechanism unit II)	
**	37	PZZZOP040FMC	Tap The Screw	116	REC Lever (F) (Mechanism unit II)	
**	38	PZZZOP060FMC	Tap The Screw	117	10P Wire assembly (Mechanism unit II)	
**	39	PZZZOP060FMC	Tap The Screw	118	2P Head Wire assembly (Mechanism unit II)	
**	40	119	
**	41	120	6P Head Wire assembly (Mechanism unit II)	
**	42	121	Blinder	
**	43				
**	44				
**	45				

A

B

C

D

A

B

C

D

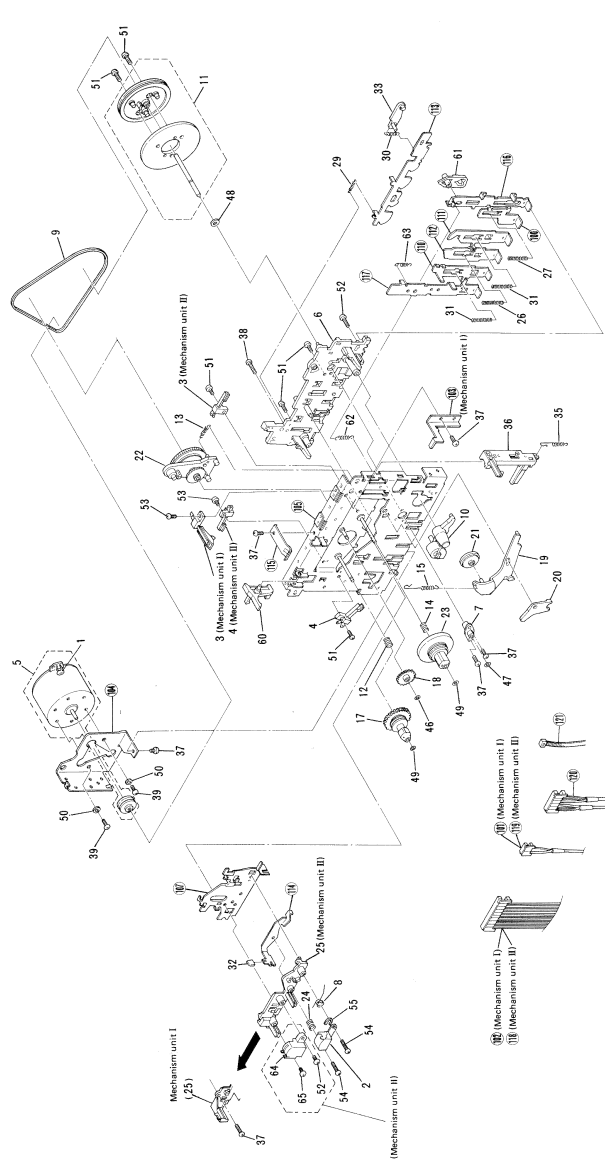

T.C. Corp
10 New York St
Wharton NJ 07785
www.servicemanuals.net