

Mark No. Description Parts No.

76	1 MECHA UNIT	EXK2020
77	2 MECHA UNIT	EXK2010
78	DAMPER ASSEMBLY	AXAI008
79	REMOTE CONTROL UNIT (CU-DC022)	AXD1183
80	SCREW	BEZ30P060FZK
81	SCREW	BEZ30P080FZK
82	SCREW	BFZ26P080FMC
83	NUT	NK90FUC
84	SCREW	VPZ30P080FMC
85	SCREW	VPZ30P080FZK
86	FUSE (T2.5A, FU101)	AEK-403
87	FUSE (T2A, FU102)	AEK-017
88	FUSE (T800mA, FU151)	AEK-031
89	FUSE (T800mA, FU152)	AEK-031
90	POWER TRANSFORMER (T2001)	ATS1322

A

- 91 1 MECHA ASSEMBLY
- 92 2 MECHA ASSEMBLY

B

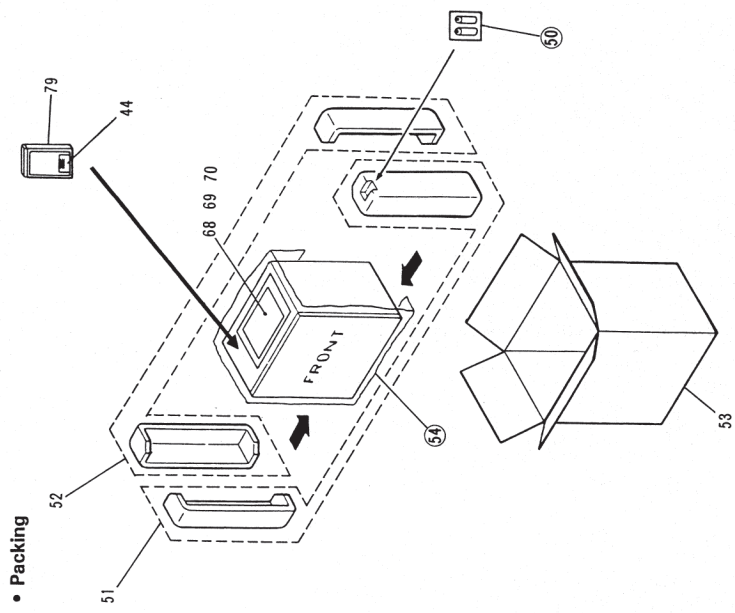

• Packing

• Exterior

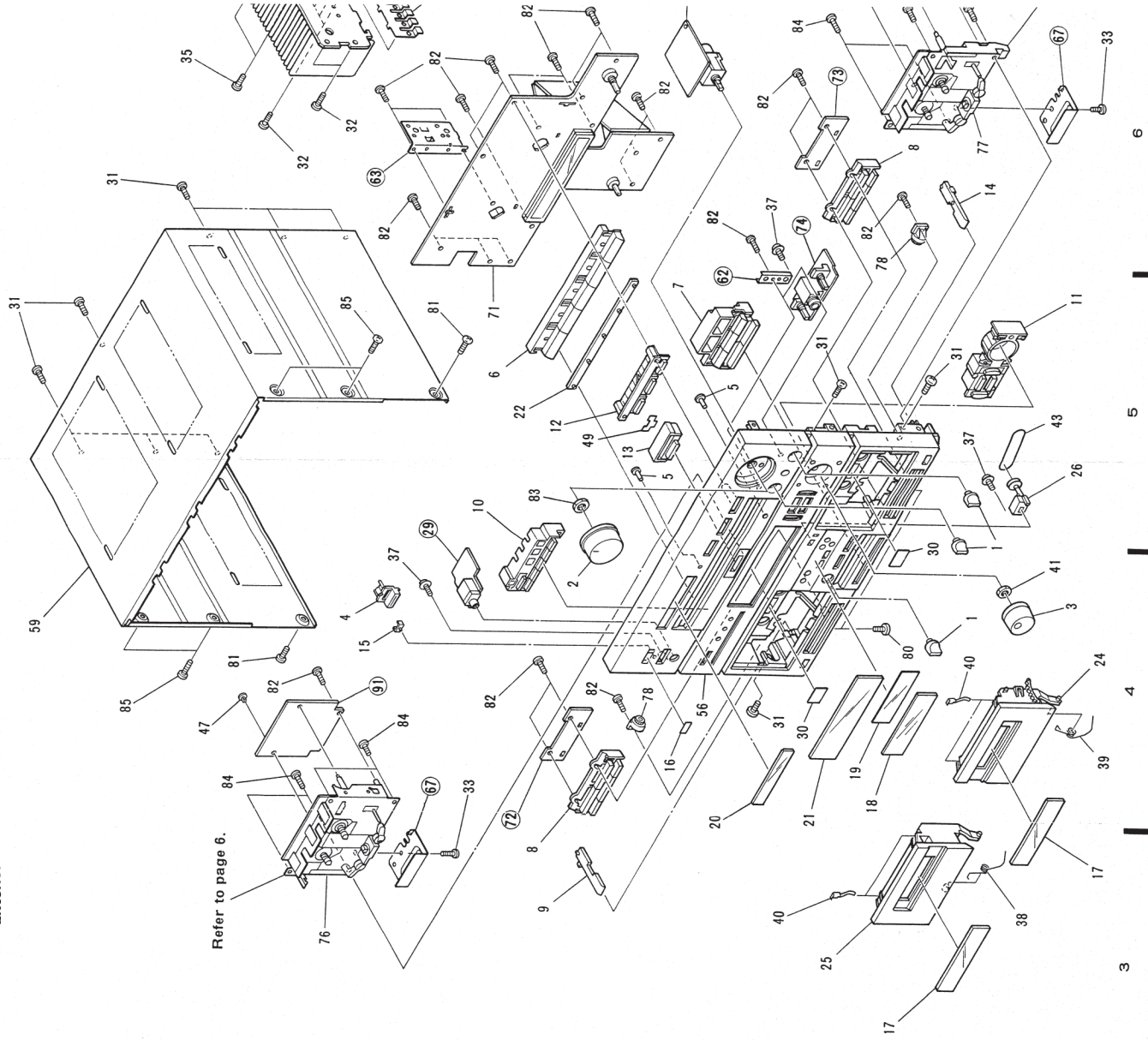

Refer to page 6.

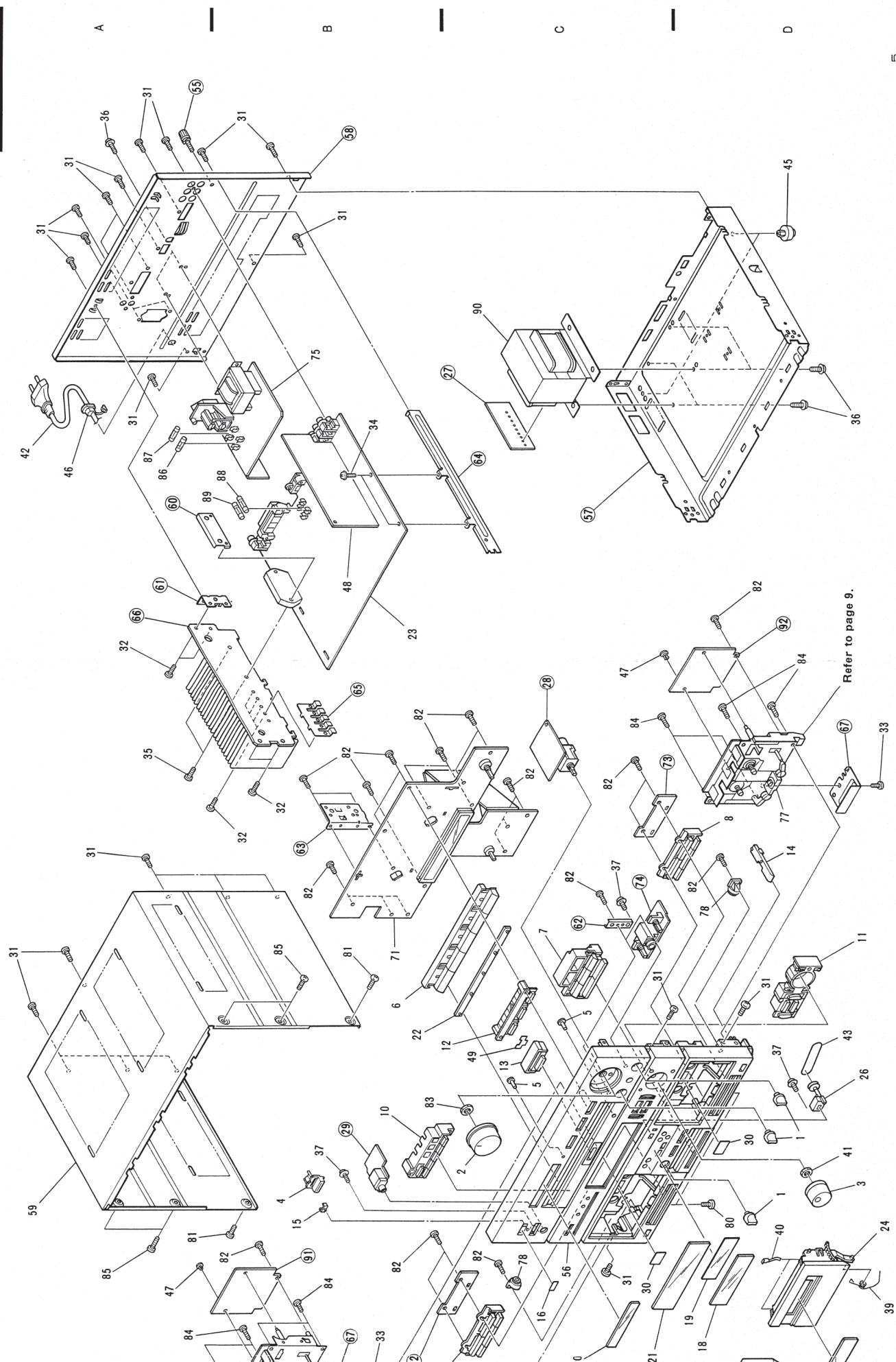

Note :
 When removing the chassis unit to replace the arm unit (EXX1003), the chassis unit can be easily removed by cutting the $\text{\textcircled{A}}$ part of No.55 (1/2) with a nippers, etc. (see following illustration).

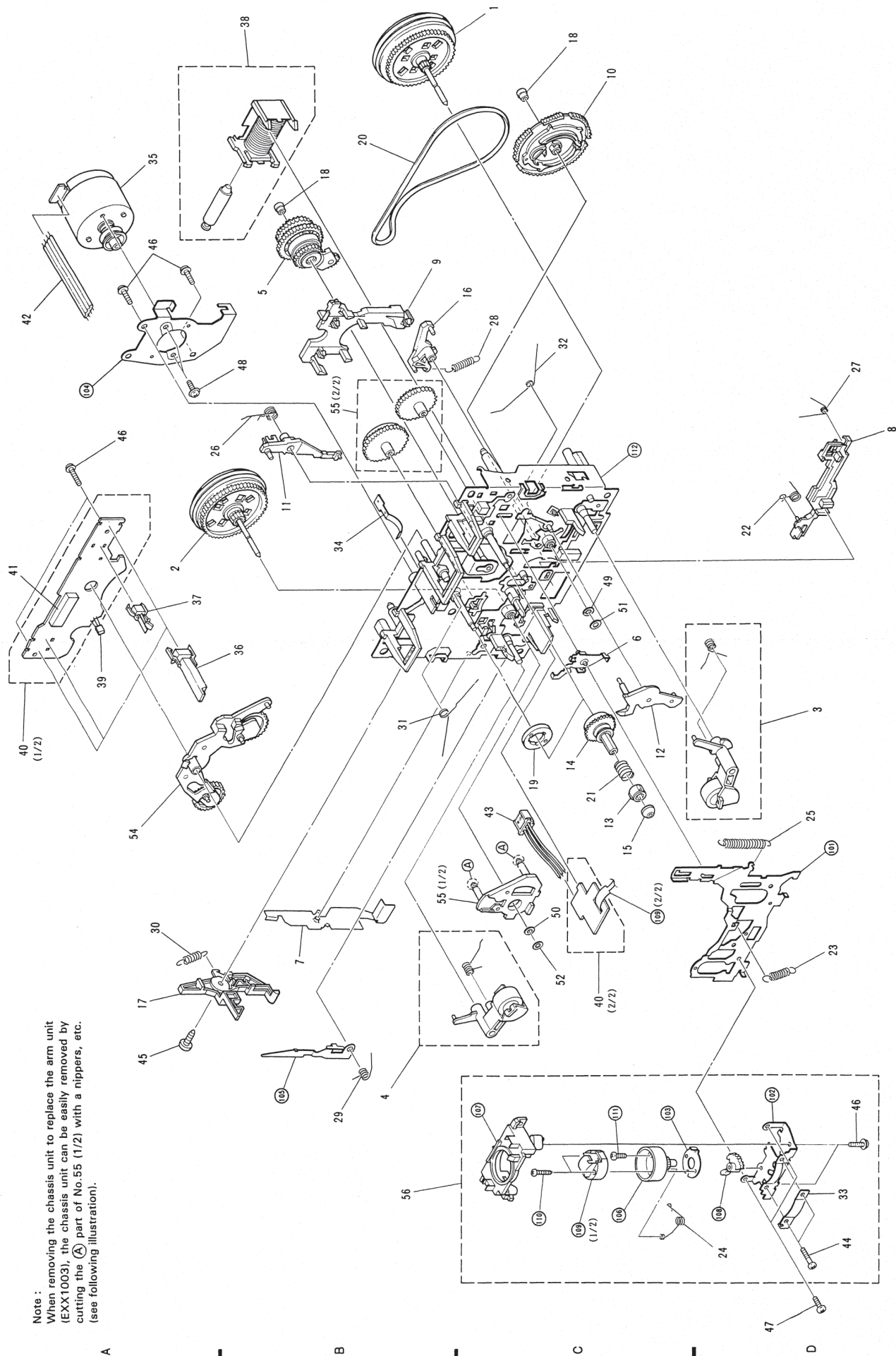

A

B

C

D

A

B

C

D

6

5

4

3

2

1

6

5

4

3

2

1

7

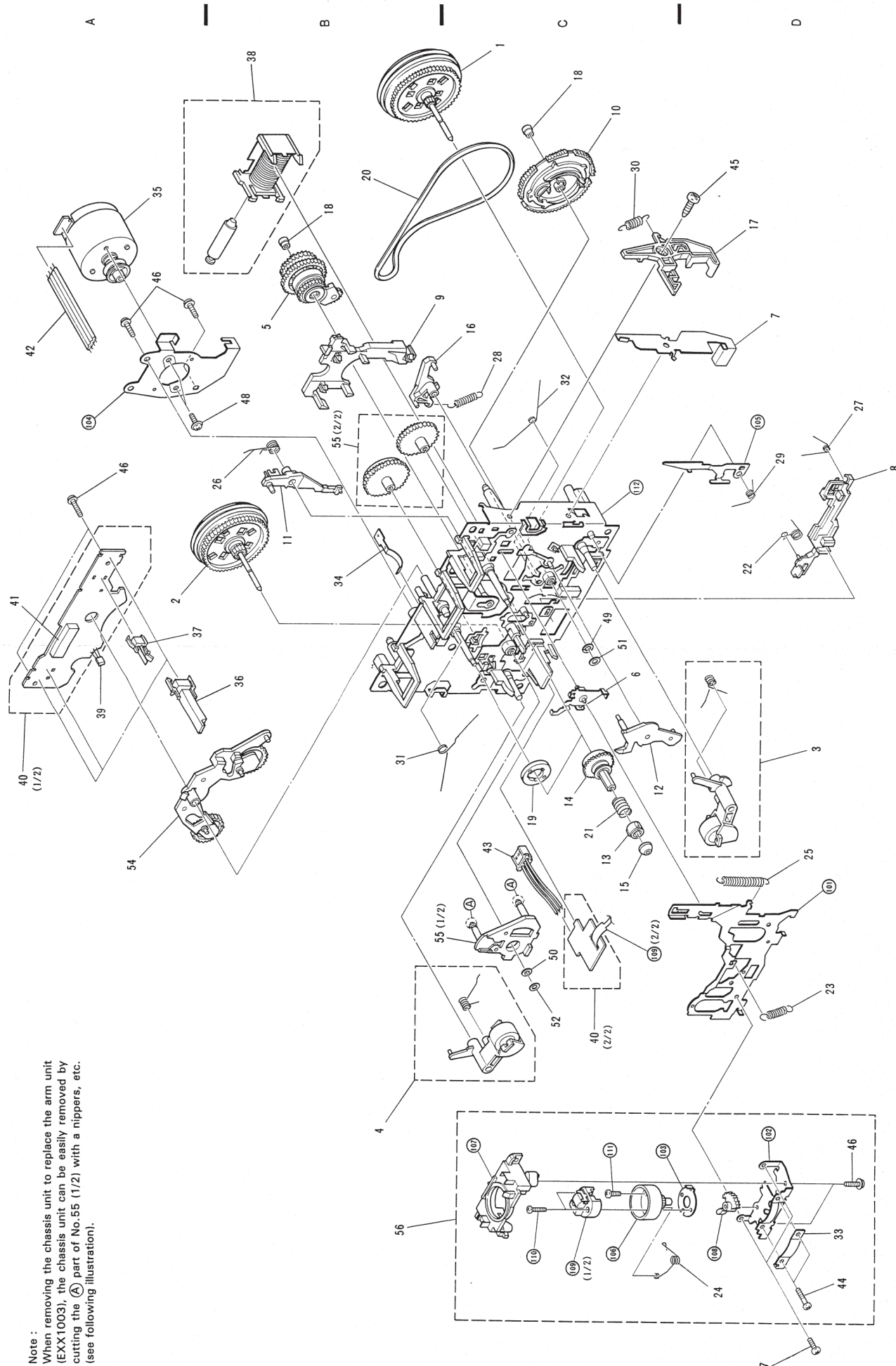

Note :
 When removing the chassis unit to replace the arm unit (EXX1003), the chassis unit can be easily removed by cutting the **(A)** part of No.55 (1/2) with a nippers, etc. (see following illustration).

1 2 3 4 5 11

1 2 3 4 5 6 11