

**CABINET PARTS LOCATION**

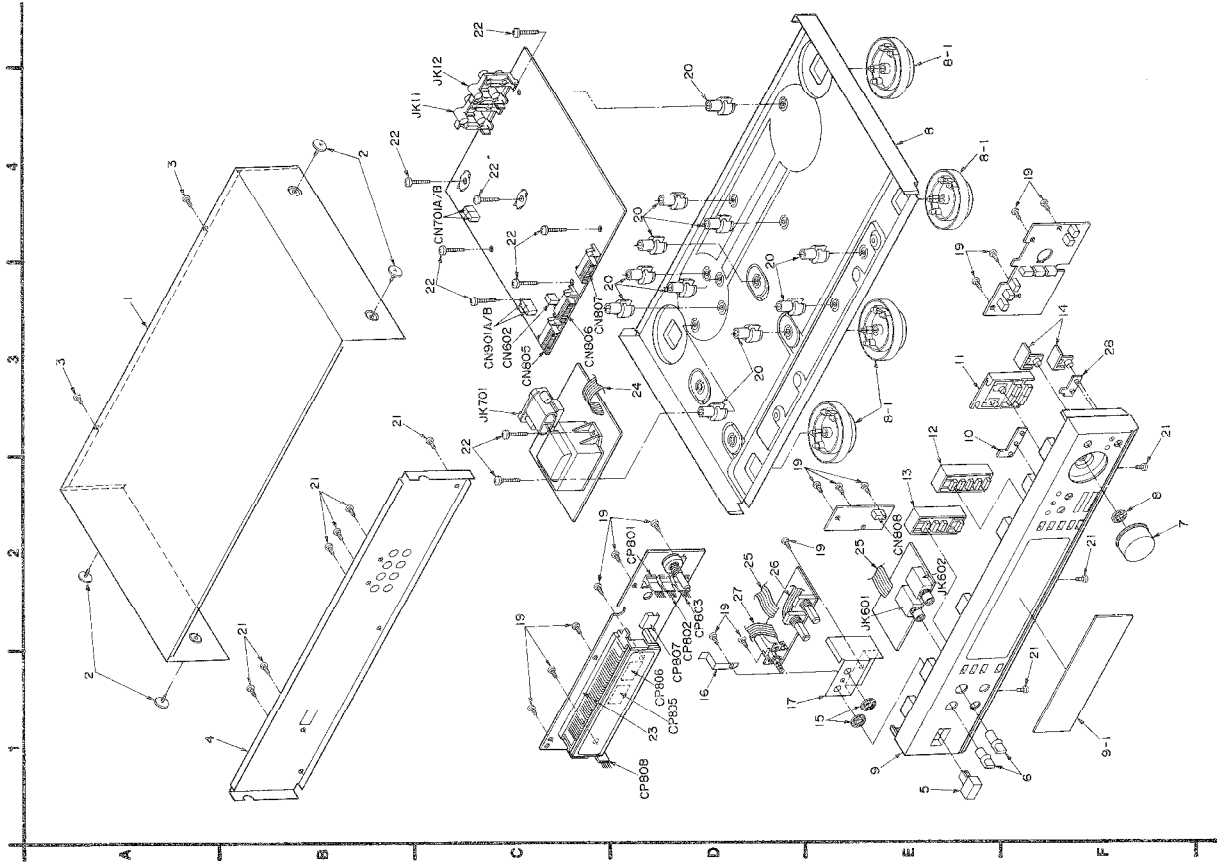

Ref. No.	Part No.	Part Name & Description	Remarks
		CABINET PARTS	
1	RK0078-1K	CABINET	
2	SRE2129-1	SCREW	
3	XTR83-8JFZ1	SCREW	(E)
4	RK0151A-B1	REAR PANEL	(E)
4	RK0151A-C1	REAR PANEL	(E)
4	RK0151A-A1	REAR PANEL	(E)
4	RK0151B-A1	REAR PANEL	(G)
4	RK0151A-C1	REAR PANEL	(G)
5	RK0030	POWER BUTTON	
6	RK0046	MIC VOLUME ROBB	
7	RK0155-K	JUG CONTROL SWCH	
8	RFK1K690E-X	BUTTON BOARD ASS'Y	
9-1	R60053-A	FOOT	
9	RFN089E-X	FRONT PANEL ASS'Y	
9-1	RK021-K	FL PANEL	
10	RFN089E-X	FRONT PANEL ASS'Y	
11	RK0780-K	SELECT BUTTON (A)	
12	RK0781-K	SELECT BUTTON (B)	
13	RK0781A-K	SELECT BUTTON (C)	
14	RK0782-K	MONITOR BUTTON	
15	RN00001	NUT	
16	RN0183	EARTH SPRING	
17	RN0188	ANGLE	
18	SNE40Z1-1	NUT	
19	XTR826-6J	SCREW	
20	SNE187-2	P.C.B. SPACER	
21	XTR83-8JFZ1	SCREW	
22	XTR9-2QUZ7	SCREW	
23	RN0156	FL HOLDER	
24	RN1806110RQ	FLAT CABLE (EP)	
25	RN1806110RQ	FLAT CABLE (EP) (JRB01)	
26	RN1806200RQ	FLAT CABLE (GP) (JRB02)	
27	RN1806200RQ	FLAT CABLE (GP) (JRB01)	
28	RFN089E-X	FRONT PANEL ASS'Y	
		PACKING MATERIALS	
P1	RP0C1344	PACKING CASE	
P2	RP0628	PAD	
P3	RP0164	ACCESSORY PAD	
P4	XZBS06A2Z	PROTECTION COVER	
P5	XZB24C4064	PROTECTION COVER	
		ACCESSORIES	
A1	RFN089E-X	FRONT PANEL ASS'Y	(E)
A1	RK0153-B	REAR PANEL	(E)
A1	RFN089E-X	FRONT PANEL ASS'Y	(E)
A1	RFN089E-X	FRONT PANEL ASS'Y	(G)

Ref. No.	Part No.	Part Name & Description	Remarks
A1	RK0163-B	INSTRUCTIONS MANUAL	(G)
A2	RK0013	WARRANTY CARD	(E, ER, EB)
A2	RK0432A	WARRANTY CARD	(G)
A3	RK00169	SERVICE CENTER LIST	
A4	RK0019-1K	AC POWER SUPPLY CORD	△ (E, ED)
A4	SA183	AC POWER SUPPLY CORD	△ (EB)
A4	RJ4004	AC POWER SUPPLY CORD	△ (G)
A4	SA173	AC POWER SUPPLY CORD	△ (G)
A5	SJP276	STEREO CONNECTION CABLE	△ (G)
A6	SJP215	POWER TAPLE ADAPTOR	△ (G)

**PACKAGING**

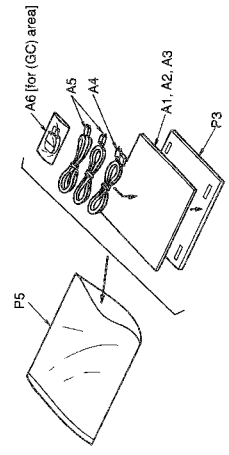

P2  
Pad A ⊕ ⊕ ⊕ ass'y: RPND628