

31 ~ 69	1-1, 1, 4, 5, N15, 6, 7, 8, 9, 10, N1, 18, N6, 16, N6, N16, N1, N14, 27, N6, N4, 28, N1, N11, 13, N1, N4, 24, 19, 2, 21, N5, 17, N5, 25, 21, 13, 12, N1, 11, 13, 11, 34, 23, 36, 23, 35
30 ~ 31	30, N1, N3, N1, N1, N1, 13, 22, N4, N4, 12, N1, N4, 13, 29, N6, N6, 21, N5, N5, N6, 22, 3, N4, 22, N6, N3, N2, N2, N10, N11, N18, 3, N19, N19, N6, N7, N8, N2, N6, N5, N6, 38, 39, 40, 31, 51, 31, 23, 32, 44, 23, 33, 23
	46, 45, 55, 52, 52, 53, 43, 42, 47, 52, 63, 61-3, 67, 61-1, 66, 62, 61-2, 61-3, 68, 64, 65

Note: When changing mechanism parts, apply the specified grease to the areas marked "X" shown in the drawing.

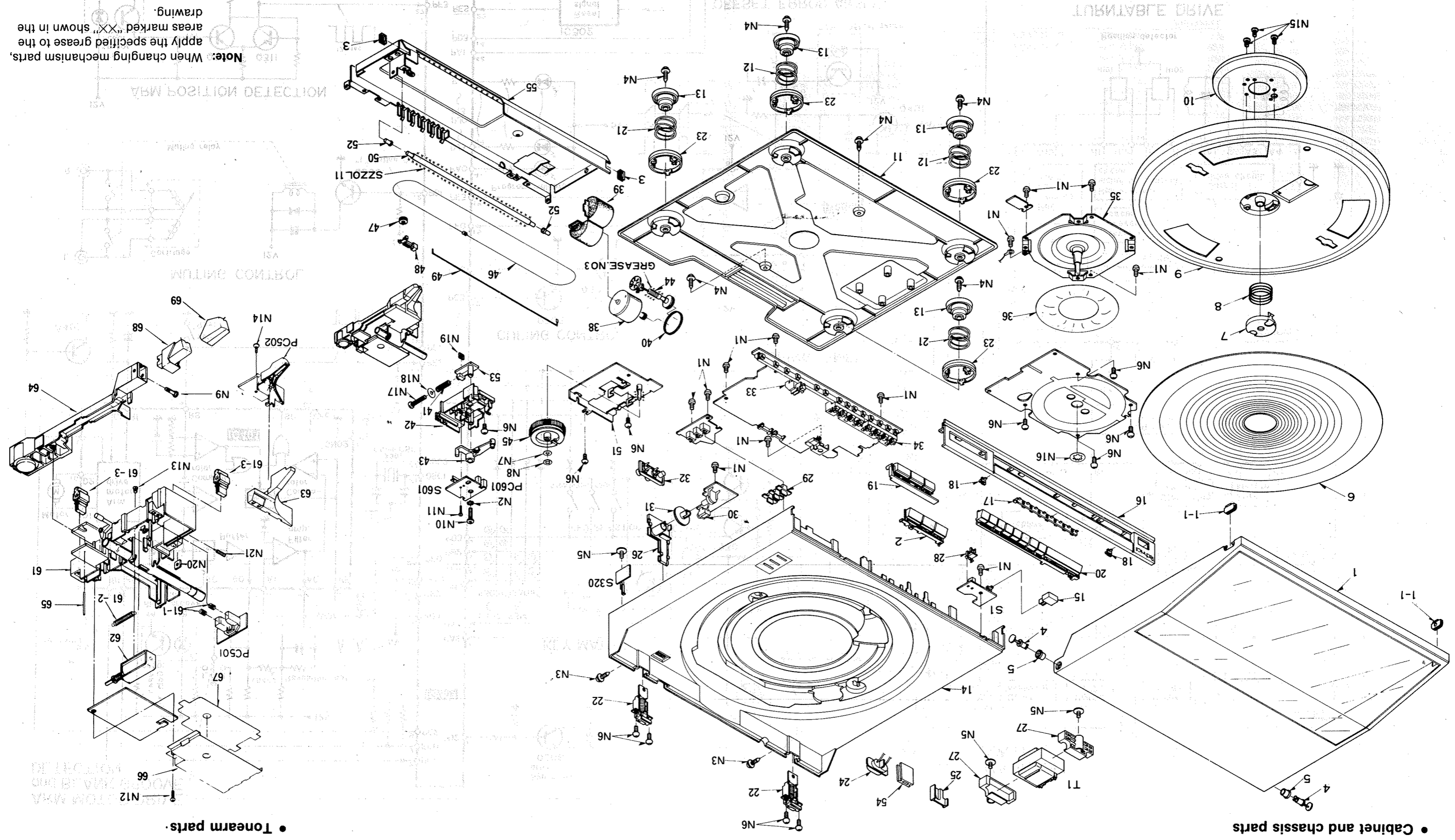

● EXPLODED VIEW
● Cabinet and chassis parts

● Tonarm parts.

REPRODUCTION BY THE NATIONAL ARCHIVES